

Elgin Avenue, Maida Vale, London W9

£500,000



Presenting this incredible, one bed, one bath apartment with an abundance of outside space. Comprising of a large, open-plan reception and kitchen with doors leading through to the amazing private garden space. Close to Little Venice, Westbourne Grove & Notting Hill.

- Ladbrooke Grove (12 minutes/0.6 miles)
- Westbourne Grove (14 minutes/0.7 miles)
- Maida Vale (16 minutes/0.8 miles)
- Kilburn Park (16 minutes/0.8 miles)
- Kilburn High Road (20 minutes/1 miles)

- Bedrooms: 1
- Receptions : 1
- Bathrooms: 1
- Property Type: Flat
- One bed
- Open plan
- Abundance of Outside Space
- Fitted Wardrobes
- Bright & Airy
- Close to Little Venice, Westbourne Grove & Notting Hill.

Call 020 7759 2199 to view this property, or visit www.vitaproperties.co.uk for more details

27 Northways Parade, College Crescent, London, NW3 5DN | T: 020 7759 2199 | E: enquiries@vitaproperties.co.uk

We make all efforts to ensure this information is accurate, but we can't guarantee it.

Elgin Avenue, Maida Vale, London W9

£500,000



Call 020 7759 2199 to view this property, or visit www.vitaproperties.co.uk for more details

27 Northways Parade, College Crescent, London, NW3 5DN | T: 020 7759 2199 | E: enquiries@vitaproperties.co.uk

We make all efforts to ensure this information is accurate, but we can't guarantee it.

Elgin Avenue, Maida Vale, London W9

£500,000

Elgin Avenue, W9

Approximate gross internal area

53.42 sq m / 575 sq ft

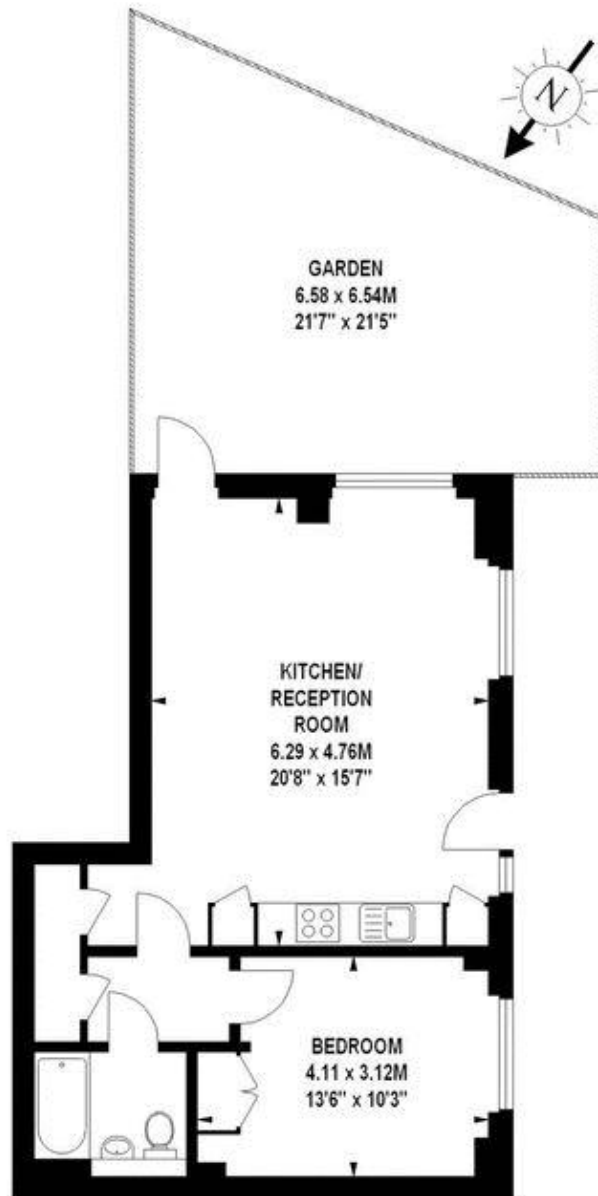

Ground Floor

The floor plan is not to scale and measurements and areas shown are approximate and therefore should be used for illustrative purposes only.

The plan has been prepared in accordance with the RICS code of Measuring Practice and whilst we have confidence in the information produced, it must be not be relied on.

If there is any aspect of particular importance, you should carry out or commission your own inspection of the property.

Copyright of FeaturePRO.

Call 020 7759 2199 to view this property, or visit www.vitaproperties.co.uk for more details

27 Northways Parade, College Crescent, London, NW3 5DN | T: 020 7759 2199 | E: enquiries@vitaproperties.co.uk

We make all efforts to ensure this information is accurate, but we can't guarantee it.

Elgin Avenue, Maida Vale, London W9

£500,000

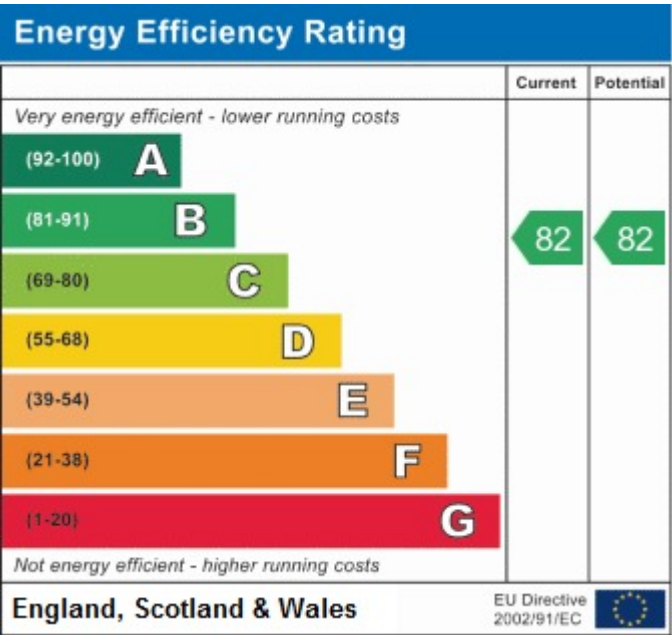
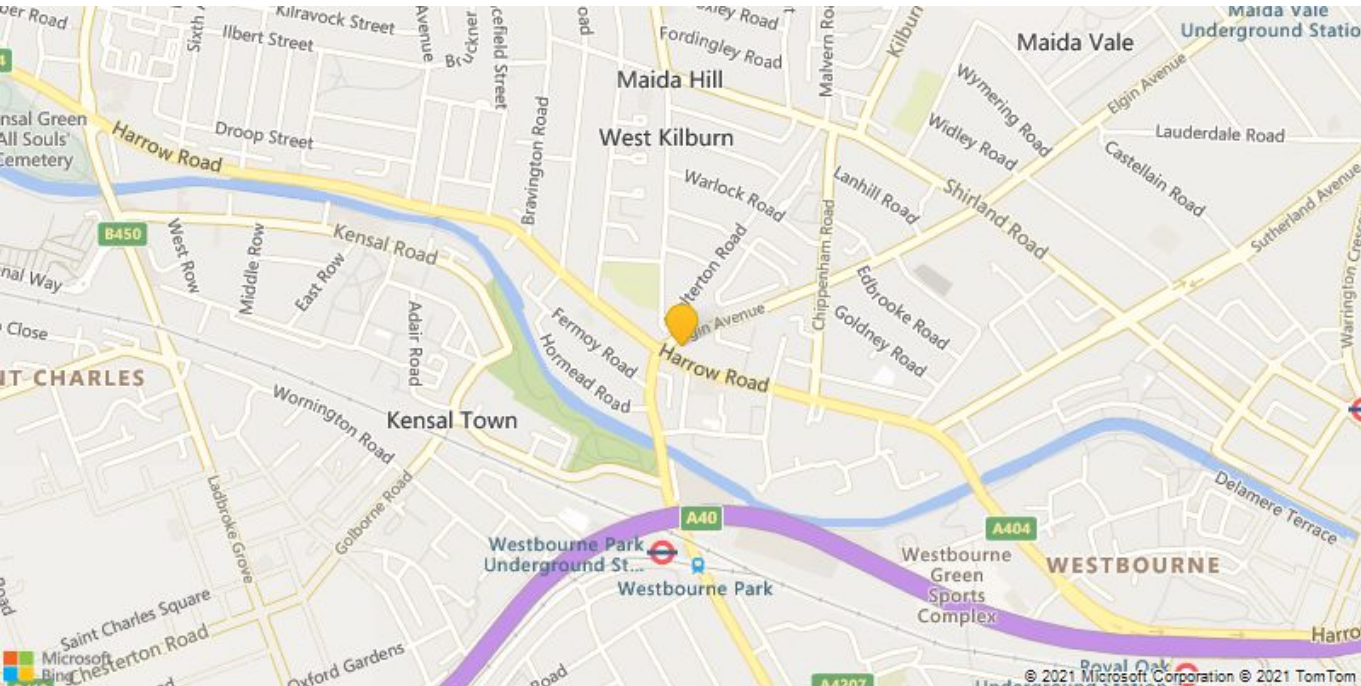

Call 020 7759 2199 to view this property, or visit www.vitaproperties.co.uk for more details