



Athena Court

FINCHLEY ROAD, ST JOHNS WOOD, LONDON NW8

£10,000



Set within the prestigious Athena Court, this outstanding four-bedroom penthouse apartment offers an exceptional standard of living in the heart of St John's Wood. Recently renovated to an exacting standard, the property presents a rare opportunity to rent a home that seamlessly combines contemporary luxury, generous proportions, and everyday practicality. From the moment you enter, the quality of craftsmanship and attention to detail are evident, creating a refined yet welcoming atmosphere throughout. At the heart of the apartment lies an expansive reception room, designed to accommodate both elegant entertaining and relaxed day-to-day living. Flooded with natural light, this impressive space is enhanced by large windows that frame far-reaching panoramic views across London, offering a striking and ever-changing outlook. The reception room opens directly onto a substantial private terrace, one of the home's most notable features. This superb outdoor space is ideal for al fresco dining, social gatherings, or simply enjoying a quiet moment while taking in the city skyline. The property comprises four generously sized double bedrooms, each thoughtfully designed as a private retreat. A key highlight of this penthouse is that every bedroom benefits from its own en-suite bathroom, all finished to a high specification with

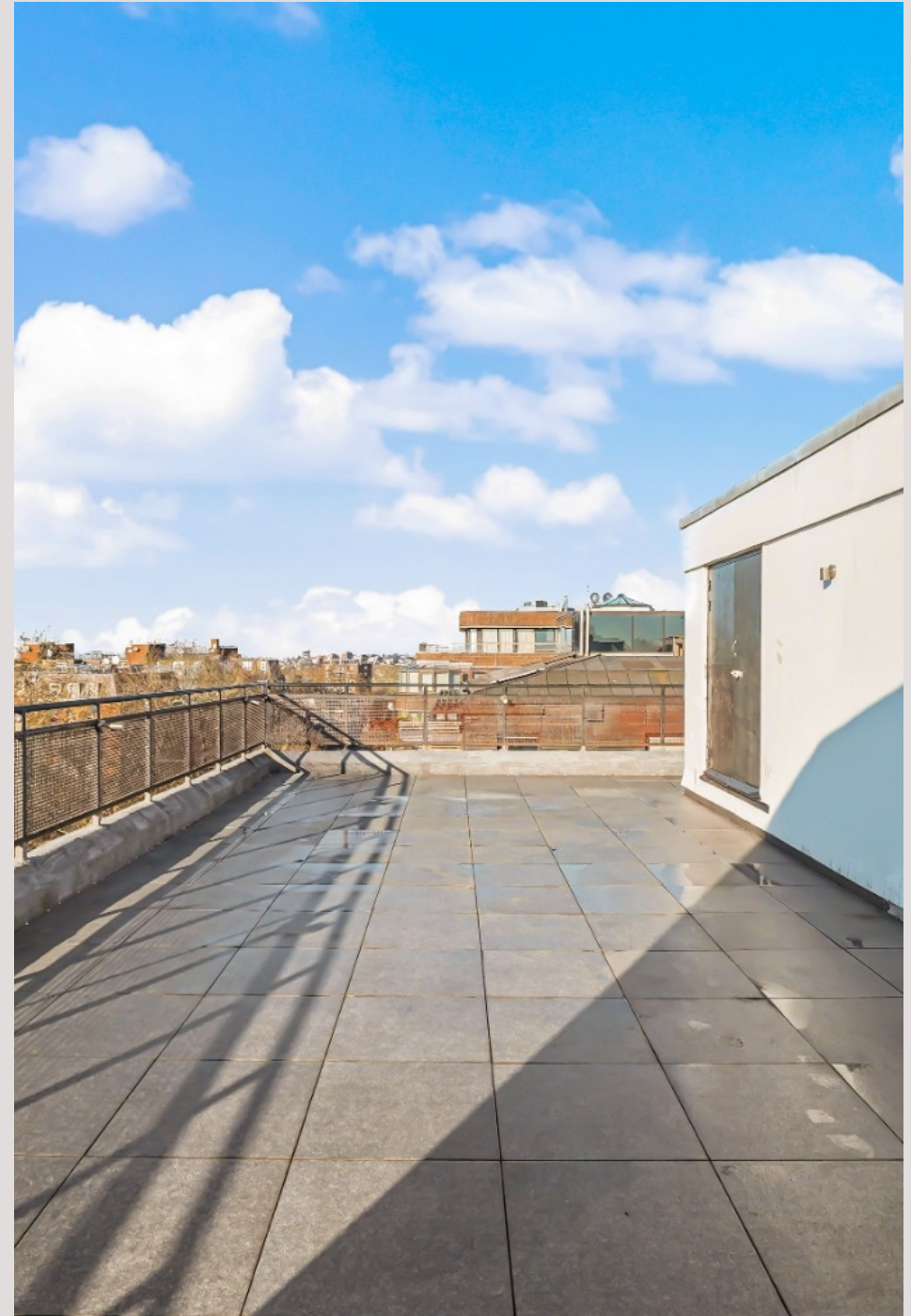



Additional features include secure parking and direct lift access to the apartment, enhancing both comfort and exclusivity. The recent refurbishment extends throughout the property, including a stylish modern kitchen with integrated appliances, updated heating, and sophisticated lighting, ensuring a smooth and hassle-free tenancy.

Athena Court is superbly located just seconds from the Underground station, providing excellent connectivity across London. St John's Wood High Street, with its boutiques, cafés, and restaurants, is close by, while Regent's Park is moments away, offering vast green spaces and renowned attractions. This penthouse truly delivers refined London living in an unrivalled location.









Scan for out video walkthrough



Approximate Area = 2753 sq ft / 255.7 sq m

For identification only - Not to scale

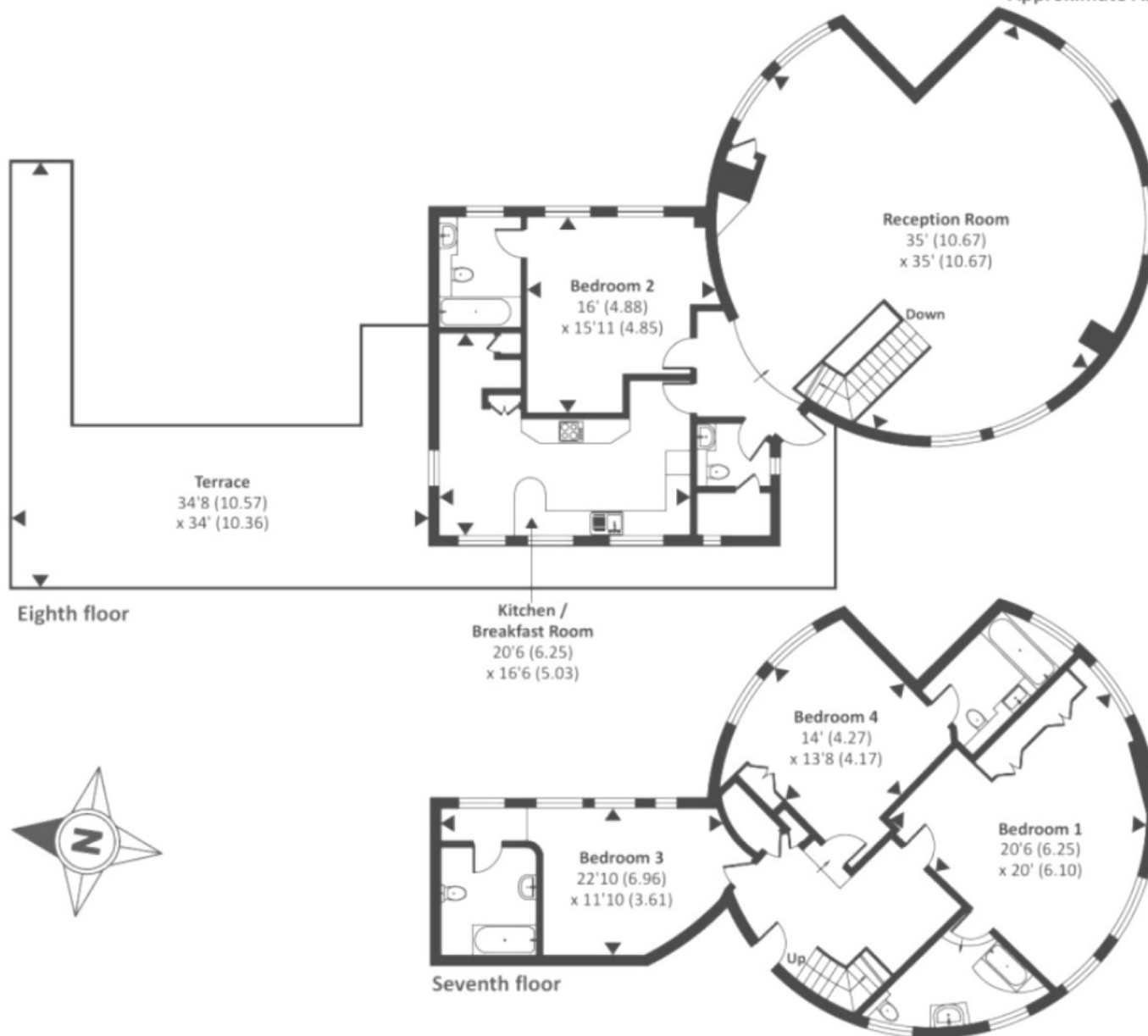

Particulars

Property

Athena Court, Finchley Road, St Johns Wood, London NW8
£10,000

Rooms



1



4



4

Features

- Penthouse Apartment with Panoramic Views
- Renovated
- Large Terrace
- Lift & Parking by Sep Negotiation

Information

Council Tax

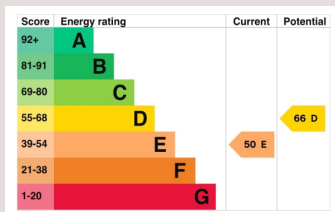

Oliver Kent

oliver.kent@vitaproperties.uk
+4477 7274 0351



Scan for our website





T: +4420 7759 2199
E: enquiries@vitaproperties.uk

Disclaimer: These particulars are prepared as a general guide for prospective purchasers or tenants and do not constitute, nor constitute part of, an offer or contract. All statements, descriptions, and measurements contained herein are given in good faith and are believed to be correct at the time of printing, but any intending purchaser or tenant should not rely on them as statements or representations of fact and must satisfy themselves by inspection or otherwise as to their correctness. Floor plans and photographs are for illustrative purposes only and may not be to scale. The position and size of doors, windows, appliances, and other features are approximate. Anti-Money Laundering (AML): In line with the Money Laundering, Terrorist Financing and Transfer of Funds Regulations 2017, we are required to carry out customer due diligence checks. Buyers/tenants will be asked to provide proof of identity, address, and source of funds before a sale or rental can be agreed. Data Protection (GDPR): Personal information supplied to Vita Properties will be processed in accordance with the General Data Protection Regulation (GDPR). Your details may be retained for legitimate business purposes relating to property services. Full details of our Privacy Policy are available on request.

All rights reserved.