



Northways

COLLEGE CRESCENT, SWISS COTTAGE, LONDON NW3

£575



Available immediately - This modern 2-bedroom flat is located in the sought-after Swiss Cottage neighborhood of London and is available for rent. As you enter the property, you will be greeted by a bright and inviting living room that is perfect for relaxing and entertaining.

The living room is equipped with large windows that provide plenty of natural light, as well as beautiful hardwood floors that add to the character of the space.

The flat features a fitted separate kitchen, fully fitted with modern appliances and ample storage, ideal for home cooking.

The bedroom is well-proportioned, comfortably fitting a double bed and has large windows that allow plenty of natural light to shine through.

The bathroom is modern and well-maintained, with a shower over the bathtub.





The flat is located on a quiet tree-lined street, just a short walk from all the amenities it offers. It's also only a stone's throw away from the tube station, which offers a quick access to Central London and other parts of the city. With its prime location, well-appointed interior, and peaceful atmosphere, this flat is the ideal home for anyone looking to rent in the Swiss Cottage area. Hot Water and Heating Included - Offered on a Furnished basis











Northways College, Crescent, NW3

Approximate Gross Internal Area = 751 sq ft / 69.8 sq m

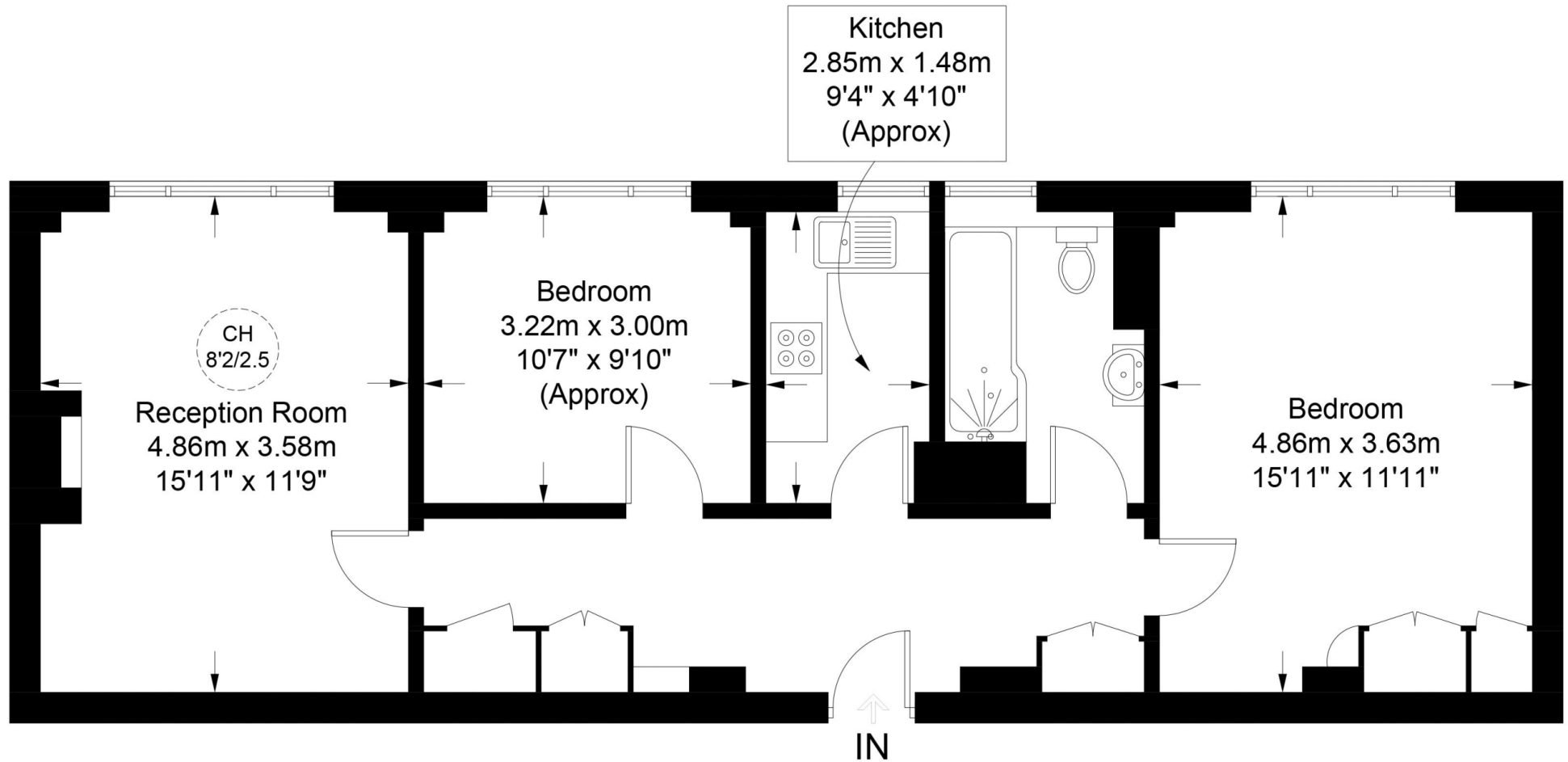

First Floor



**Certified
Property
Measurer**

This plan is for layout guidance only. Not drawn to scale unless stated. Windows and door openings are approximate. Whilst every care is taken in the preparation of this plan, please check all dimensions, shapes and compass bearings before making any decisions reliant upon them. (ID932840)

Particulars

Property

Northways, College Crescent, Swiss Cottage, London NW3
£575

Rooms



Features

- Furnished
- Wooden Floors
- Seconds to Swiss Cottage Tube
- Two double bedrooms

Information

Council Tax

Energy efficiency rating for this property

This property's current energy rating is C. It has the potential to be B.

[See how to improve this property's energy performance.](#)

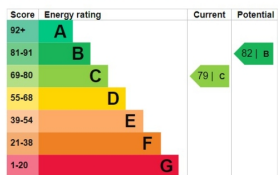

Scan for our website





T: +4420 7759 2199

E: enquiries@vitaproperties.uk

Disclaimer: These particulars are prepared as a general guide for prospective purchasers or tenants and do not constitute, nor constitute part of, an offer or contract. All statements, descriptions, and measurements contained herein are given in good faith and are believed to be correct at the time of printing, but any intending purchaser or tenant should not rely on them as statements or representations of fact and must satisfy themselves by inspection or otherwise as to their correctness. Floor plans and photographs are for illustrative purposes only and may not be to scale. The position and size of doors, windows, appliances, and other features are approximate. Anti-Money Laundering (AML): In line with the Money Laundering, Terrorist Financing and Transfer of Funds Regulations 2017, we are required to carry out customer due diligence checks. Buyers/tenants will be asked to provide proof of identity, address, and source of funds before a sale or rental can be agreed. Data Protection (GDPR): Personal information supplied to Vita Properties will be processed in accordance with the General Data Protection Regulation (GDPR). Your details may be retained for legitimate business purposes relating to property services. Full details of our Privacy Policy are available on request.

All rights reserved.