



Haverstock Hill

BELSIZE PARK, LONDON NW3

£500,000



This two-bedroom home with a modern minimalist style featuring warm tones and a trendy interior is the perfect home to move into. Located in the heart of one of London's most affluent residential locations next to Regents Park, Primrose Hill and Hampstead Heath.

With exceptional transport links into the city, West End and Canary Wharf are accessed via Belsize Park and Swiss cottage walking distance.











Scan for out video walkthrough

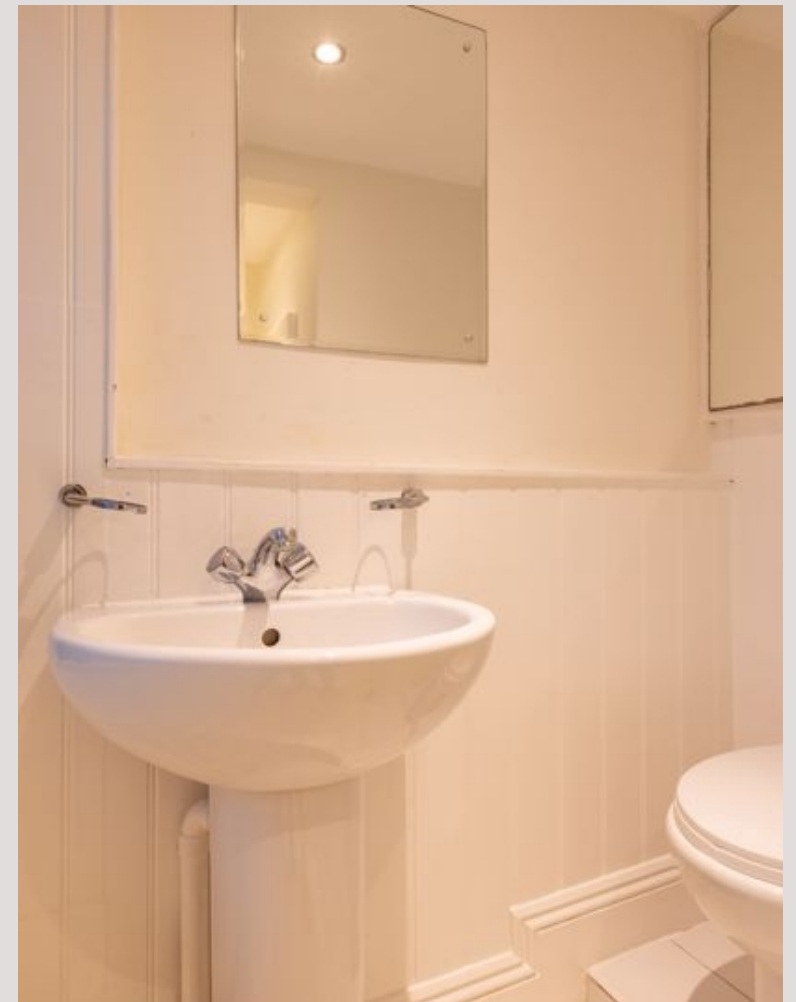

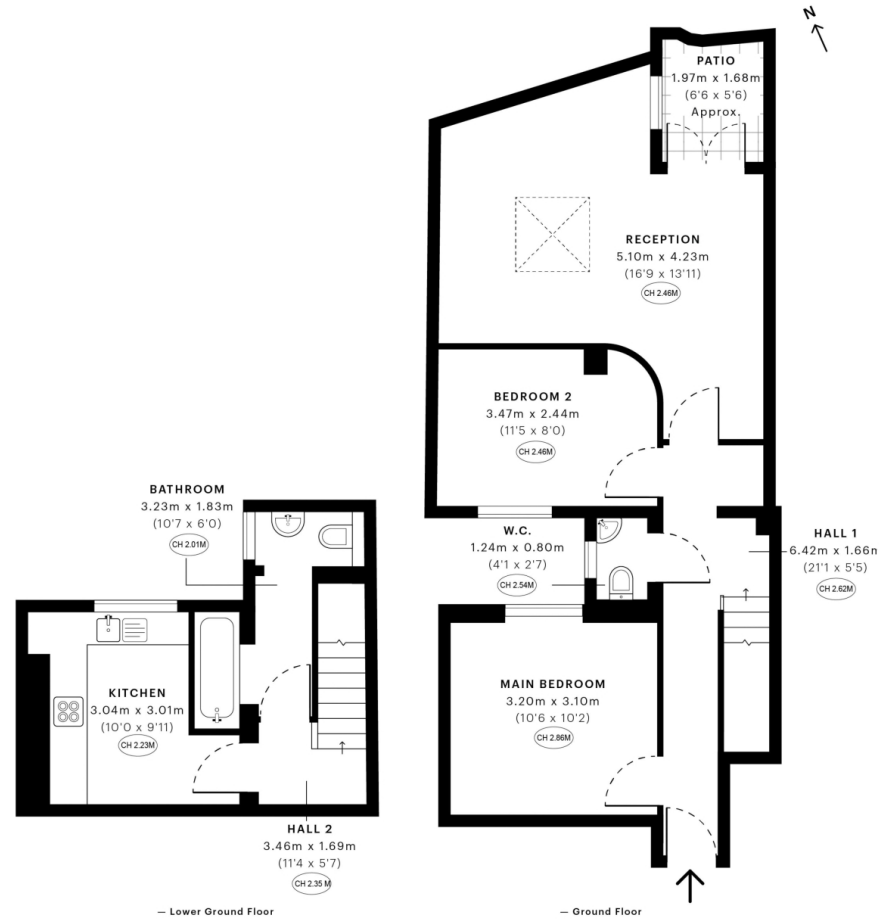

GROSS INTERNAL AREA (GIA)
The footprint of the property
69.00 sqm / 742.71 sqft

NET INTERNAL AREA (NIA)
Excludes walls and external features
Includes vestibules, restricted head height
62.07 sqm / 668.12 sqft

EXTERNAL STRUCTURAL FEATURES
Balconies, terraces, verandas etc.
0.00 sqm / 0.00 sqft

RESTRICTED HEAD HEIGHT
Linked use areas under 1.8m
0.00 sqm / 0.00 sqft



Spec Verified floor plans are produced in accordance with Royal Institution of Chartered Surveyors' Property Measurement Standards. Plans and gardens are illustrative only and excluded from all area calculations. Due to rounding, numbers may not add up precisely. All measurements shown for the individual room lengths and widths are the maximum points of measurements captured in the scan.

PM3 28 RESIDENTIAL 66.89 sqm / 719.77 sqft
PM3 30 RESIDENTIAL 62.16 sqm / 669.08 sqft

SPEC ID 5631f2310516efe0db335779e

Particulars

Property

Haverstock Hill, Belsize Park, London NW3
£500,000

Rooms



Features

- 2 Bedrooms
- Patio Garden
- Seconds to Belsize Park
- Close to Camden

Information

Council Tax



Scan for our website





T: +4420 7759 2199

E: enquiries@vitaproperties.uk

Disclaimer: These particulars are prepared as a general guide for prospective purchasers or tenants and do not constitute, nor constitute part of, an offer or contract. All statements, descriptions, and measurements contained herein are given in good faith and are believed to be correct at the time of printing, but any intending purchaser or tenant should not rely on them as statements or representations of fact and must satisfy themselves by inspection or otherwise as to their correctness. Floor plans and photographs are for illustrative purposes only and may not be to scale. The position and size of doors, windows, appliances, and other features are approximate. Anti-Money Laundering (AML): In line with the Money Laundering, Terrorist Financing and Transfer of Funds Regulations 2017, we are required to carry out customer due diligence checks. Buyers/tenants will be asked to provide proof of identity, address, and source of funds before a sale or rental can be agreed. Data Protection (GDPR): Personal information supplied to Vita Properties will be processed in accordance with the General Data Protection Regulation (GDPR). Your details may be retained for legitimate business purposes relating to property services. Full details of our Privacy Policy are available on request.

All rights reserved.