



Crediton Hill

WEST HAMPSTEAD, LONDON NW6

£1,100,000



A Freehold Single Storey Dwelling with Planning Permission to Redevelop and Excavate to A Three Bedroom House

Location

The property is situated in the sought after area of West Hampstead on a residential road close to local shops and amenities. The open spaces of West Hampstead Hockey Club and Hampstead Heath are within easy reach. Transport links are provided by Finchley and Frognal overground and West Hampstead rail station.

Description

The property comprises a single storey dwelling arranged over first floor levels.

Planning

Camden Borough Council granted the following planning permission (ref: 2018/1012/P) on 02-10-2018: 'Provision of a new basement extension below existing single-storey premises, minor amendments to elevations and formation of new landscaped patio garden'.











Scan for out video walkthrough



Architectural & Planning
Studio, 20 Crediton Hill, NY 11

**EXISTING SITE BLOCK PLAN
& GROUND FLOOR PLAN**

Site No. 5611101
Studio, 20 Crediton Hill, NY 11

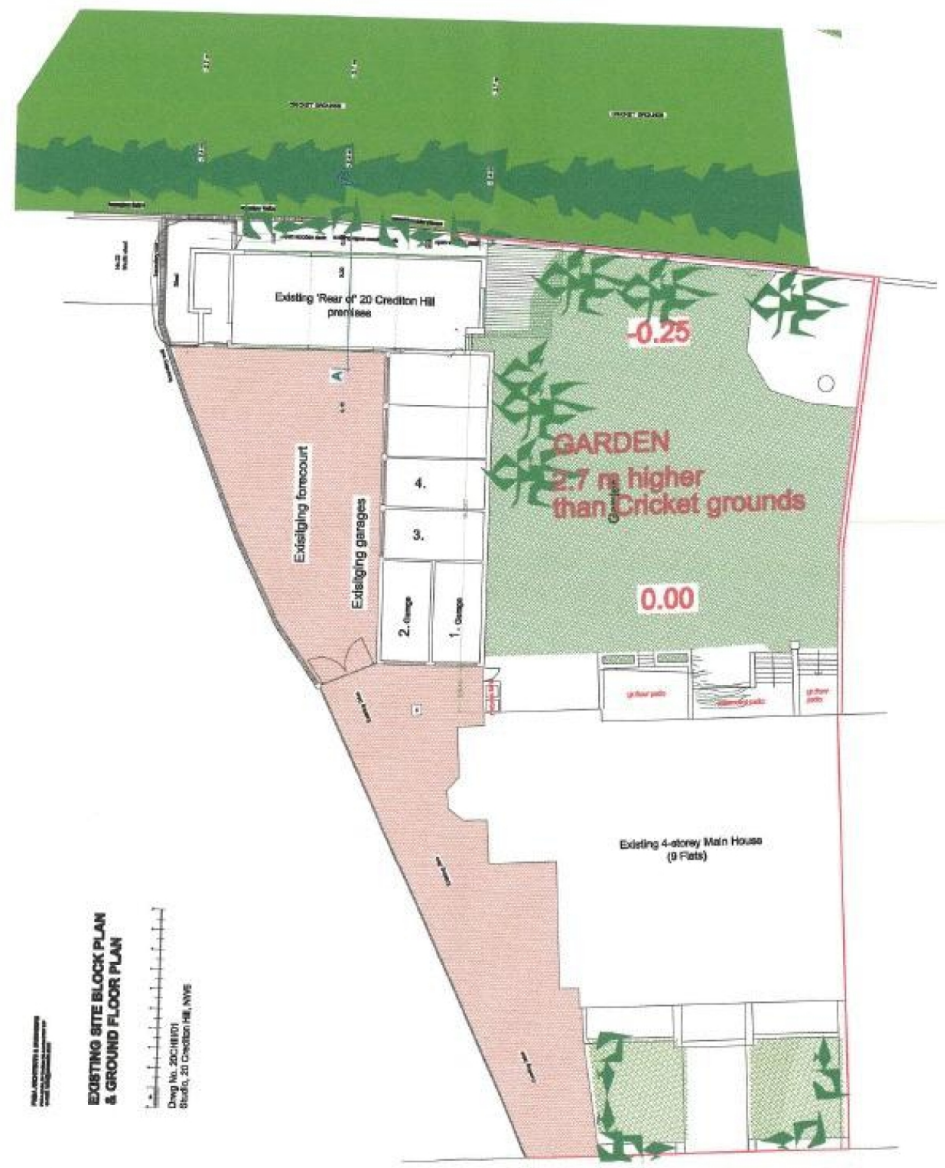

Particulars

Property

Crediton Hill, West Hampstead, London NW6
£1,100,000

Rooms



2



1



3

Information

Council Tax

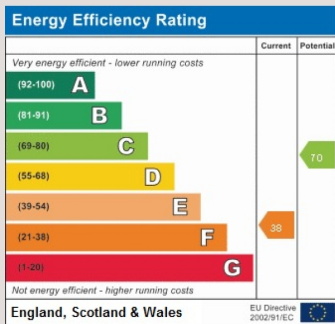

Features

- A Freehold Single Storey Dwelling with Planning Permission to Redevelop and Excavate to A Three Bedroom House
- LAND AND PREMISES AT THE REAR directly overlooking 5 Acres of Cricket Grounds
- Viewings highly recommended
- Check out the walk through video!



Oliver Kent

oliver.kent@vitaproperties.uk
+4477 7274 0351



Scan for our website





T: +4420 7759 2199
E: enquiries@vitaproperties.uk

Disclaimer: These particulars are prepared as a general guide for prospective purchasers or tenants and do not constitute, nor constitute part of, an offer or contract. All statements, descriptions, and measurements contained herein are given in good faith and are believed to be correct at the time of printing, but any intending purchaser or tenant should not rely on them as statements or representations of fact and must satisfy themselves by inspection or otherwise as to their correctness. Floor plans and photographs are for illustrative purposes only and may not be to scale. The position and size of doors, windows, appliances, and other features are approximate. Anti-Money Laundering (AML): In line with the Money Laundering, Terrorist Financing and Transfer of Funds Regulations 2017, we are required to carry out customer due diligence checks. Buyers/tenants will be asked to provide proof of identity, address, and source of funds before a sale or rental can be agreed. Data Protection (GDPR): Personal information supplied to Vita Properties will be processed in accordance with the General Data Protection Regulation (GDPR). Your details may be retained for legitimate business purposes relating to property services. Full details of our Privacy Policy are available on request.

All rights reserved.