



Fitzjohns Avenue  
HAMPSTEAD, LONDON NW3

£1,000,000



Offered chain free and with the share of freehold – An excellent two double bedroom raised ground floor apartment with a balcony forming part of a grand double fronted red brick house with parking and communal gardens.

This beautifully presented apartment boast high ceilings, well proportioned rooms and a balcony with access to impressive communal gardens.

This imposing building has parking available on a first come first served basis as well as being superbly located for access to Hampstead Village, Finchley Road and Belsize Park.





Offered chain free and with the share of freehold  
- An excellent two double bedroom raised ground floor apartment with a balcony forming part of a grand double fronted red brick house with parking and communal gardens.

This beautifully presented apartment boast high ceilings, well proportioned rooms and a balcony with access to impressive communal gardens.

This imposing building has parking available on a first come first served basis as well as being superbly located for access to Hampstead Village, Finchley Road and Belsize Park.









Approximate gross internal area 863 sq ft - 80 sq m

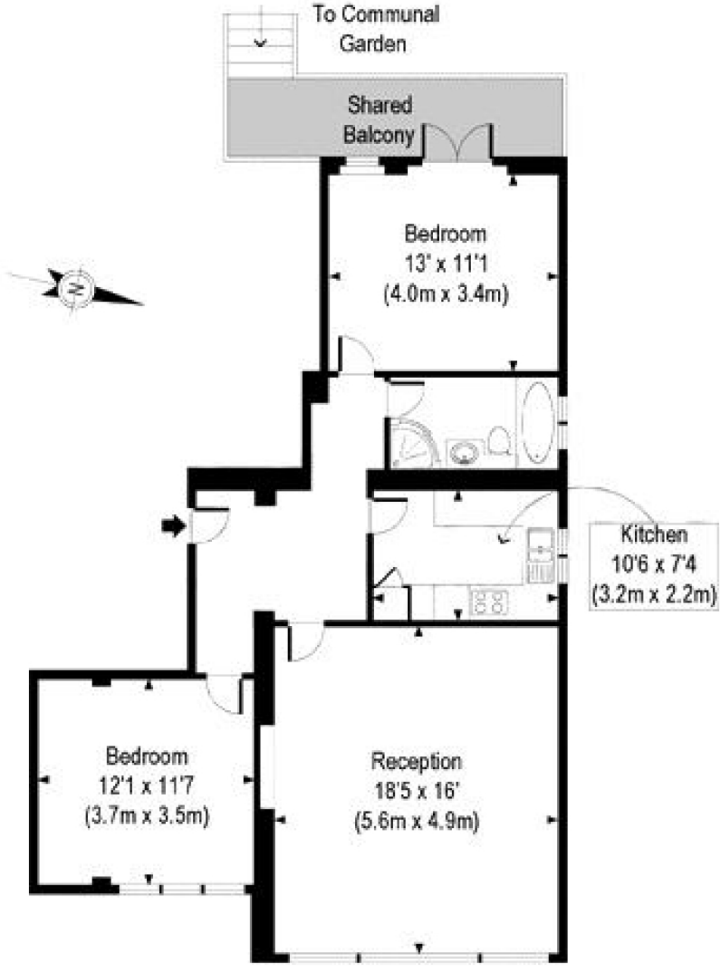

Raised Ground Floor

# Particulars

## Property

Fitzjohns Avenue, Hampstead, London NW3  
£1,000,000

## Rooms



1



1



2

## Features

- 2 Bedrooms : Bathroom :
- Reception Room
- Communal Gardens
- Seconds to Hampstead Village
- Off Street Parking on a first come first serve basis

## Information

Council Tax

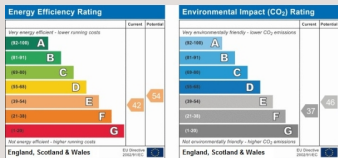

Oliver Kent

oliver.kent@vitaproperties.uk  
+4477 7274 0351



Scan for our website





T: +4420 7759 2199  
E: [enquiries@vitaproperties.uk](mailto:enquiries@vitaproperties.uk)

Disclaimer: These particulars are prepared as a general guide for prospective purchasers or tenants and do not constitute, nor constitute part of, an offer or contract. All statements, descriptions, and measurements contained herein are given in good faith and are believed to be correct at the time of printing, but any intending purchaser or tenant should not rely on them as statements or representations of fact and must satisfy themselves by inspection or otherwise as to their correctness. Floor plans and photographs are for illustrative purposes only and may not be to scale. The position and size of doors, windows, appliances, and other features are approximate. Anti-Money Laundering (AML): In line with the Money Laundering, Terrorist Financing and Transfer of Funds Regulations 2017, we are required to carry out customer due diligence checks. Buyers/tenants will be asked to provide proof of identity, address, and source of funds before a sale or rental can be agreed. Data Protection (GDPR): Personal information supplied to Vita Properties will be processed in accordance with the General Data Protection Regulation (GDPR). Your details may be retained for legitimate business purposes relating to property services. Full details of our Privacy Policy are available on request.

All rights reserved.