



Dobson Close

LONDON, SWISS COTTAGE NW6

£1,100,000



Presenting a contemporary maisonette in the heart of NW6!

This immaculately presented property is split across two levels and is located in a quiet neighbourhood on a low traffic street. The ground floor comprises a stunning, open-plan kitchen and reception room, which is beautifully illuminated thanks to clever light-enhancing design implements such as the two skylights and the full wall-panning, glass 'Pivot and Slide' doors out to the garden. The bespoke kitchen is German made and offers an island counter with a breakfast bar and fully-implemented Miele and Fisher and Paykel appliances. The garden is of very generous proportions and comprises both a patio and lawn area with in-built seating. Finally, on this floor, you have the first of four double bedrooms, with this one also offering an en-suite shower room. Upstairs are the final three double bedrooms, additional storage and a three-piece family bathroom containing a Lusso stone bathtub with a rainfall shower. Further benefits include access to a large, enclosed, communal garden.





Enviably located for transport links from Swiss Cottage Station (Jubilee Line), Finchley Road Station (Metropolitan Line) and South Hampstead Station (Overground), as well as the many shops, restaurants and other amenities of Finchley Road, Hampstead and St John's Wood.









Dobson Close, NW6



Approximate Gross Internal Area = 969 sq ft / 90.0 sq m
(Excluding Shed)

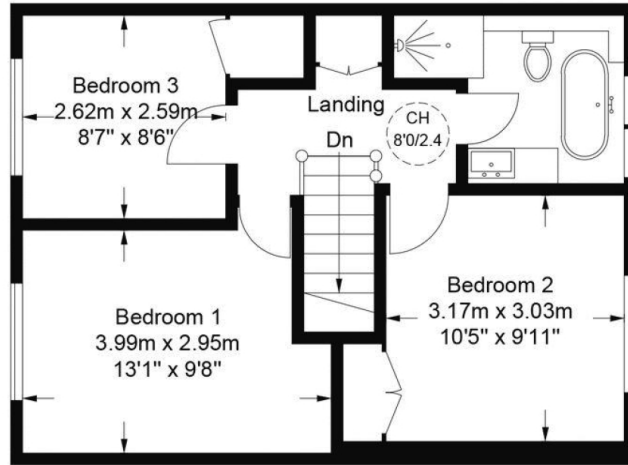

First Floor

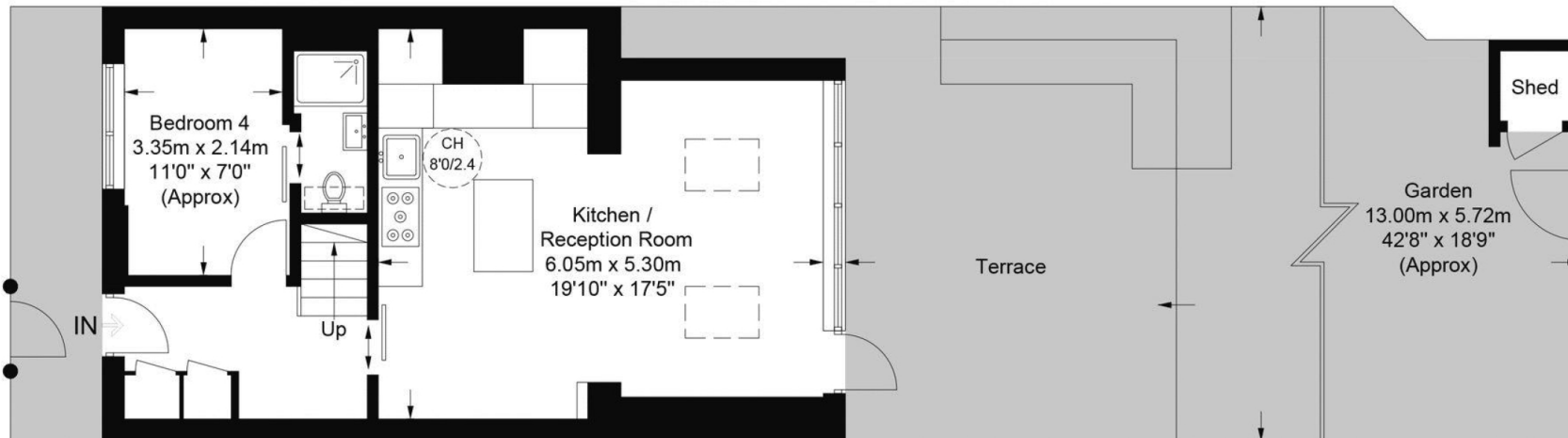

Ground Floor

This plan is for layout guidance only. Not drawn to scale unless stated. Windows and door openings are approximate. Whilst every care is taken in the preparation of this plan, please check all dimensions, shapes and compass bearings before making any decisions reliant upon them. (ID821573)

Particulars

Property

Dobson Close, London, Swiss Cottage NW6
£1,100,000

Rooms



Features

- Maisonette
- 4 Bed, 2 Bath
- Bright & Contemporary
- Immaculately Presented

Information

Council Tax

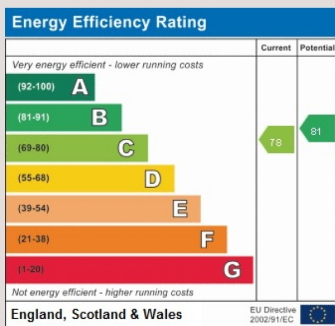

Oliver Kent

oliver.kent@vitaproperties.uk
+4477 7274 0351



Scan for our website





T: +4420 7759 2199
E: enquiries@vitaproperties.uk

Disclaimer: These particulars are prepared as a general guide for prospective purchasers or tenants and do not constitute, nor constitute part of, an offer or contract. All statements, descriptions, and measurements contained herein are given in good faith and are believed to be correct at the time of printing, but any intending purchaser or tenant should not rely on them as statements or representations of fact and must satisfy themselves by inspection or otherwise as to their correctness. Floor plans and photographs are for illustrative purposes only and may not be to scale. The position and size of doors, windows, appliances, and other features are approximate. Anti-Money Laundering (AML): In line with the Money Laundering, Terrorist Financing and Transfer of Funds Regulations 2017, we are required to carry out customer due diligence checks. Buyers/tenants will be asked to provide proof of identity, address, and source of funds before a sale or rental can be agreed. Data Protection (GDPR): Personal information supplied to Vita Properties will be processed in accordance with the General Data Protection Regulation (GDPR). Your details may be retained for legitimate business purposes relating to property services. Full details of our Privacy Policy are available on request.

All rights reserved.