



Kidderpore Avenue
HAMPSTEAD, LONDON NW3

£900



Located in the highly desirable and exclusive Westfield development on Kidderpore Avenue, London NW3 is this stunning 3 bedroom 2 bathroom apartment.

Offering bright and spacious reception room with a private patio overlooking stunning manicured communal gardens, fully fitted kitchen with Bosch appliances throughout including dishwasher, 2 double bedrooms with en suite bath/shower rooms, 3rd bedroom is a large single, amazing swimming pool, sauna, Jacuzzi and gymnasium facilities, secure underground parking, lift, porter.





Located in the highly desirable and exclusive Westfield development on Kidderpore Avenue, London NW3 is this stunning 3 bedroom 2 bathroom apartment.

Offering bright and spacious reception room with a private patio overlooking stunning manicured communal gardens, fully fitted kitchen with Bosch appliances throughout including dishwasher, 2 double bedrooms with en suite bath/shower rooms, 3rd bedroom is a large single, amazing swimming pool, sauna, Jacuzzi and gymnasium facilities, secure underground parking, lift, porter.









Scan for out video walkthrough



Kidderpore Avenue NW3

APPROX. GROSS INTERNAL FLOOR AREA 1165 SQFT / 108 SQM

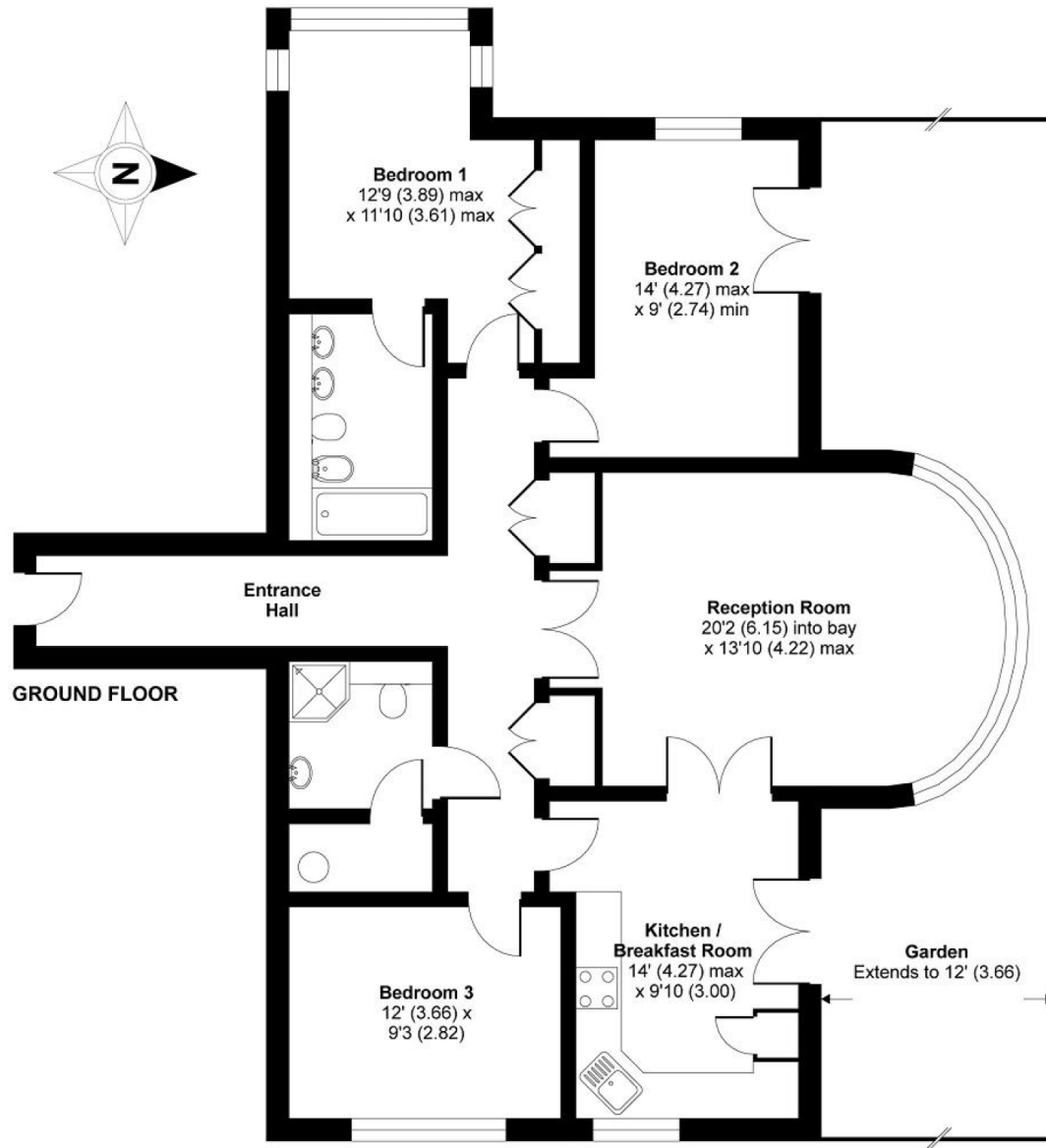

Particulars

Property

Kidderpore Avenue, Hampstead, London NW3
£900

Rooms



Features

- Private patio garden
- Porter
- Communal gardens
- Gym

Information

Council Tax

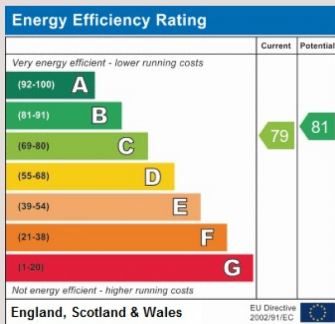

Oliver Kent

oliver.kent@vitaproperties.uk
+4477 7274 0351



Scan for our website





T: +4420 7759 2199

E: enquiries@vitaproperties.uk

Disclaimer: These particulars are prepared as a general guide for prospective purchasers or tenants and do not constitute, nor constitute part of, an offer or contract. All statements, descriptions, and measurements contained herein are given in good faith and are believed to be correct at the time of printing, but any intending purchaser or tenant should not rely on them as statements or representations of fact and must satisfy themselves by inspection or otherwise as to their correctness. Floor plans and photographs are for illustrative purposes only and may not be to scale. The position and size of doors, windows, appliances, and other features are approximate. Anti-Money Laundering (AML): In line with the Money Laundering, Terrorist Financing and Transfer of Funds Regulations 2017, we are required to carry out customer due diligence checks. Buyers/tenants will be asked to provide proof of identity, address, and source of funds before a sale or rental can be agreed. Data Protection (GDPR): Personal information supplied to Vita Properties will be processed in accordance with the General Data Protection Regulation (GDPR). Your details may be retained for legitimate business purposes relating to property services. Full details of our Privacy Policy are available on request.

All rights reserved.