



Elgin Avenue

MAIDA VALE, LONDON W9

£500,000



Presenting this incredible, one bed, one bath apartment with an abundance of outside space. Comprising of a large, open-plan reception and kitchen with doors leading through to the amazing private garden space. Close to Little Venice, Westbourne Grove & Notting Hill.





Presenting this incredible, one bed, one bath apartment with an abundance of outside space. Comprising of a large, open-plan reception and kitchen with doors leading through to the amazing private garden space. Close to Little Venice, Westbourne Grove & Notting Hill.







Elgin Avenue, W9

Approximate gross internal area

53.42 sq m / 575 sq ft

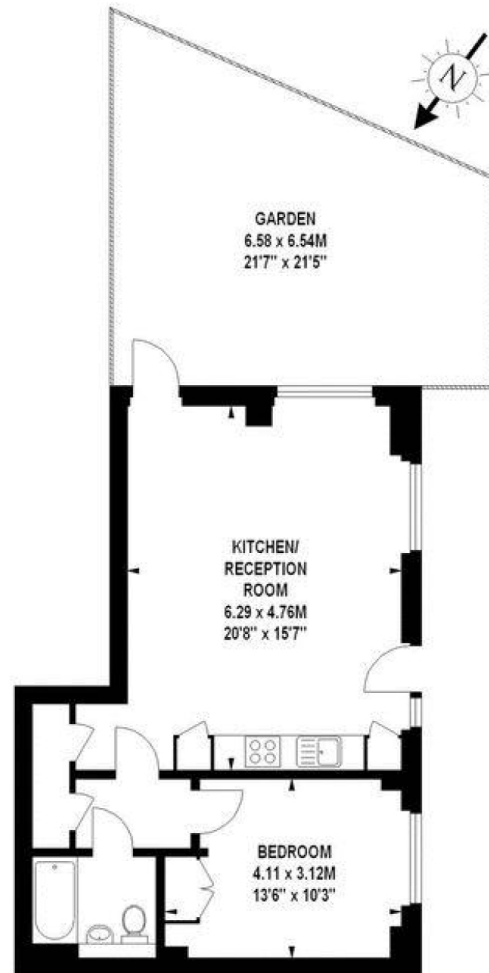

Ground Floor

The floor plan is not to scale and measurements and areas shown are approximate and therefore should be used for illustrative purposes only. The plan has been prepared in accordance with the RICS code of Measuring Practice and whilst we have confidence in the information produced, it must be not be relied on. If there is any aspect of particular importance, you should carry out or commission your own inspection of the property.
Copyright of FeaturePRO.

Particulars

Property

Elgin Avenue, Maida Vale, London W9
£500,000

Rooms



1



1



1

Features

- One bed
- Open plan
- Abundance of Outside Space
- Fitted Wardrobes

Information

Council Tax

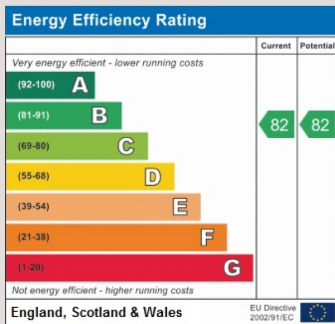

Oliver Kent

oliver.kent@vitaproperties.uk
+4477 7274 0351



Scan for our website





T: +4420 7759 2199
E: enquiries@vitaproperties.uk

Disclaimer: These particulars are prepared as a general guide for prospective purchasers or tenants and do not constitute, nor constitute part of, an offer or contract. All statements, descriptions, and measurements contained herein are given in good faith and are believed to be correct at the time of printing, but any intending purchaser or tenant should not rely on them as statements or representations of fact and must satisfy themselves by inspection or otherwise as to their correctness. Floor plans and photographs are for illustrative purposes only and may not be to scale. The position and size of doors, windows, appliances, and other features are approximate. Anti-Money Laundering (AML): In line with the Money Laundering, Terrorist Financing and Transfer of Funds Regulations 2017, we are required to carry out customer due diligence checks. Buyers/tenants will be asked to provide proof of identity, address, and source of funds before a sale or rental can be agreed. Data Protection (GDPR): Personal information supplied to Vita Properties will be processed in accordance with the General Data Protection Regulation (GDPR). Your details may be retained for legitimate business purposes relating to property services. Full details of our Privacy Policy are available on request.

All rights reserved.