



Walsingham

ST JOHNS WOOD PARK, ST JOHNS WOOD, LONDON, NW8

£850



Set on the 9th floor of a private purpose built block (with lift and portorage) in a highly desirable location in St. John's Wood is this totally renovated 2 bedroom, 2 bathroom apartment with a balcony offering fabulous views over the London skyline. Comprising a large open plan kitchen and reception room opening onto a private south-facing balcony with fantastic views, master bedroom with en-suite shower room, second double bedroom and family bathroom. Further benefits include off street parking and a private garage.

Walsingham is within short walking distance of the boutique shops, cafes, bars and restaurants on St John's Wood High Street, with the beautiful surroundings of Primrose Hill Park and Regent's Park also very close by. St. John's Wood station (Jubilee line) provides reliable transport throughout the City and West End











Scan for out video walkthrough



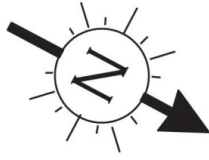

76 Walsingham

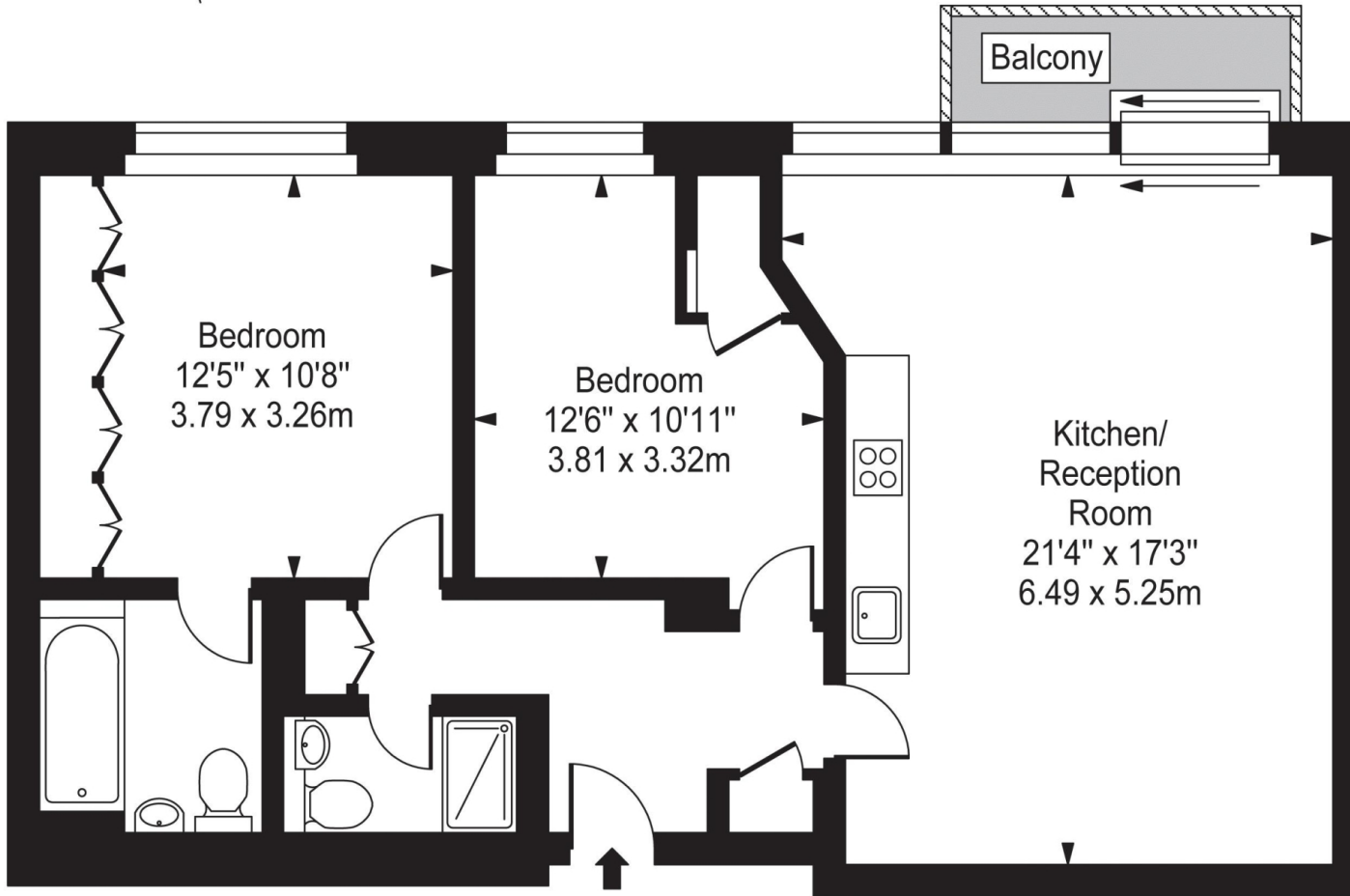

Ninth Floor



Approx Gross Internal Area **845 Sq Ft - 78.54 Sq M**

For Illustration Purposes Only - Not To Scale
Floor plan by www.creativeplanettk.com

Particulars

Property

Walsingham, St Johns Wood Park, St Johns Wood, London,
£850

Rooms



Features

- Recently refurbished
- Wooden Floors
- Fully Tiled Bathrooms
- Amazing Views

Information

Council Tax

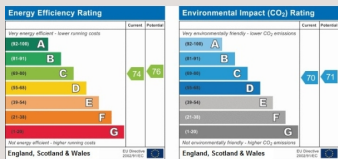

Oliver Kent

oliver.kent@vitaproperties.uk
+4477 7274 0351



Scan for our website





T: +4420 7759 2199
E: enquiries@vitaproperties.uk

Disclaimer: These particulars are prepared as a general guide for prospective purchasers or tenants and do not constitute, nor constitute part of, an offer or contract. All statements, descriptions, and measurements contained herein are given in good faith and are believed to be correct at the time of printing, but any intending purchaser or tenant should not rely on them as statements or representations of fact and must satisfy themselves by inspection or otherwise as to their correctness. Floor plans and photographs are for illustrative purposes only and may not be to scale. The position and size of doors, windows, appliances, and other features are approximate. Anti-Money Laundering (AML): In line with the Money Laundering, Terrorist Financing and Transfer of Funds Regulations 2017, we are required to carry out customer due diligence checks. Buyers/tenants will be asked to provide proof of identity, address, and source of funds before a sale or rental can be agreed. Data Protection (GDPR): Personal information supplied to Vita Properties will be processed in accordance with the General Data Protection Regulation (GDPR). Your details may be retained for legitimate business purposes relating to property services. Full details of our Privacy Policy are available on request.

All rights reserved.