



## The Courthouse

HORSEFERRY ROAD, WESTMINSTER, LONDON, SW1P

£1,150



Located within this beautiful modern development is this 3 bedroom 2 bathroom luxury apartment with two balconies is located on the on the 3rd floor (with lift) of a recently built Courthouse development in the heart Westminster.

The accommodation comprises a substantial open plan reception room with a smart fitted kitchen with Miele appliances, access to a private terrace.

Master bedroom with en suite shower room, walk in wardrobe area and another balcony.

Two further double bedrooms.

Family bathroom.

The Courthouse benefits from an excellent gymnasium, communal courtyard, 24 hour concierge and lift access to all floors.

It is located on the corner of Horseferry Road and Marsham Street, and occupies the former site of the City of Westminster Magistrates' Court.

Luxurious lobby creates a welcoming space.

Nearby transport links include Pimlico Underground Station (Victoria line) 0.5 miles, St James's Park Underground Station (Circle and District lines) 0.5 miles and Westminster Underground Station (Circle, District and Jubilee lines) 0.6 miles











# The Corthouse



Approximate Gross Internal Area = 1231 sq ft / 114.4 sq m

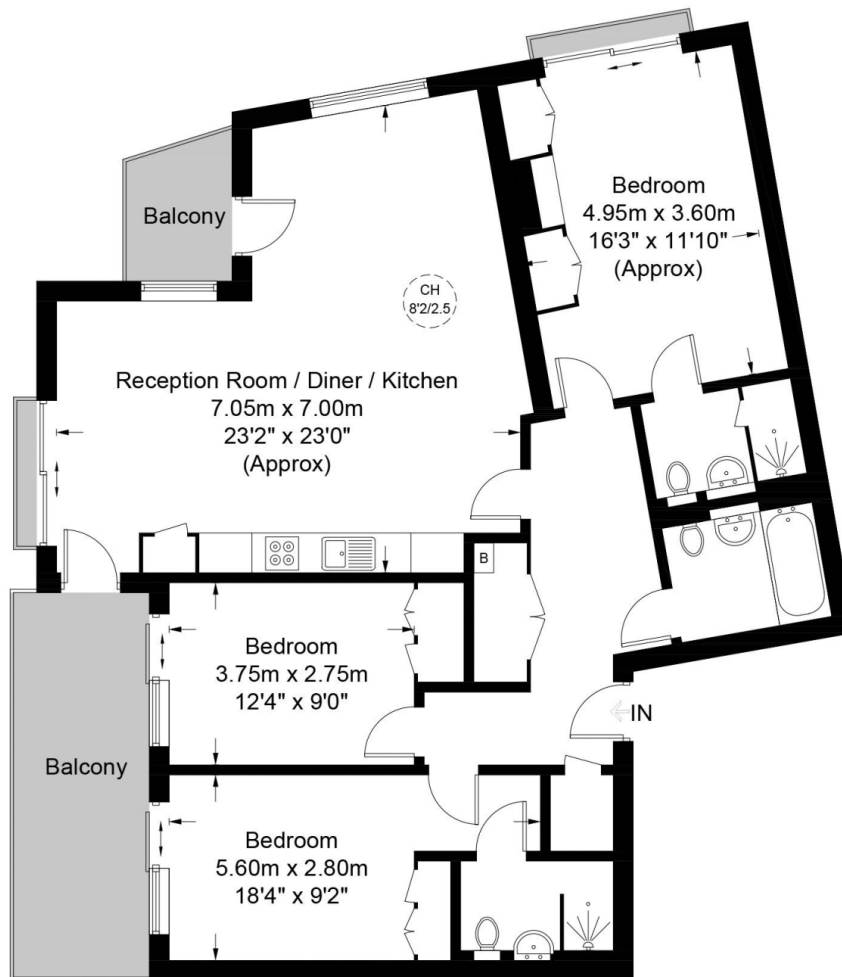

## Third Floor

This plan is for layout guidance only. Not drawn to scale unless stated. Windows and door openings are approximate. Whilst every care is taken in the preparation of this plan, please check all dimensions, shapes and compass bearings before making any decisions reliant upon them. (ID559523)

# Particulars

## Property

The Courthouse, Horseferry Road, Westminster, London,  
SW1P 0

## Rooms



1



3



3

## Features

- 3 Bedrooms : 2 Bathrooms :  
Reception Room : Kitchen
- Communal Courtyard
- 24 Hour Concierge : Gym :
- 2 Balconies : Lift :

## Information

Council Tax



Oliver Kent

[oliver.kent@vitaproperties.uk](mailto:oliver.kent@vitaproperties.uk)  
+4477 7274 0351



Scan for our website





T: +4420 7759 2199

E: [enquiries@vitaproperties.uk](mailto:enquiries@vitaproperties.uk)

Disclaimer: These particulars are prepared as a general guide for prospective purchasers or tenants and do not constitute, nor constitute part of, an offer or contract. All statements, descriptions, and measurements contained herein are given in good faith and are believed to be correct at the time of printing, but any intending purchaser or tenant should not rely on them as statements or representations of fact and must satisfy themselves by inspection or otherwise as to their correctness. Floor plans and photographs are for illustrative purposes only and may not be to scale. The position and size of doors, windows, appliances, and other features are approximate. Anti-Money Laundering (AML): In line with the Money Laundering, Terrorist Financing and Transfer of Funds Regulations 2017, we are required to carry out customer due diligence checks. Buyers/tenants will be asked to provide proof of identity, address, and source of funds before a sale or rental can be agreed. Data Protection (GDPR): Personal information supplied to Vita Properties will be processed in accordance with the General Data Protection Regulation (GDPR). Your details may be retained for legitimate business purposes relating to property services. Full details of our Privacy Policy are available on request.

All rights reserved.