



Westfield

15 KIDDERPORE AVENUE, HAMPSTEAD, LONDON, NW3

£4,500



WESTFIELD

Available 11 September 2024 is this fully refurbished and modernised, 2nd floor lateral three bedroom apartment with a balcony which is accessed from all its rooms.

Set in one of Hampstead's most reputable portered developments, the property further comprises a semi-open plan kitchen opening onto a double aspect reception room, a family bathroom and an en-suite to the master bedroom.

The building comes with lift access and offers residents the use of communal facilities including a gym, swimming pool and sauna.

Kidderpore Avenue is located within easy reach of both Hampstead Village and the convenient amenities of Finchley Road.

Offered unfurnished











Scan for out video walkthrough



Kidderpore Avenue

Approximate Gross Internal Area = 115 sq m / 1238 sq ft

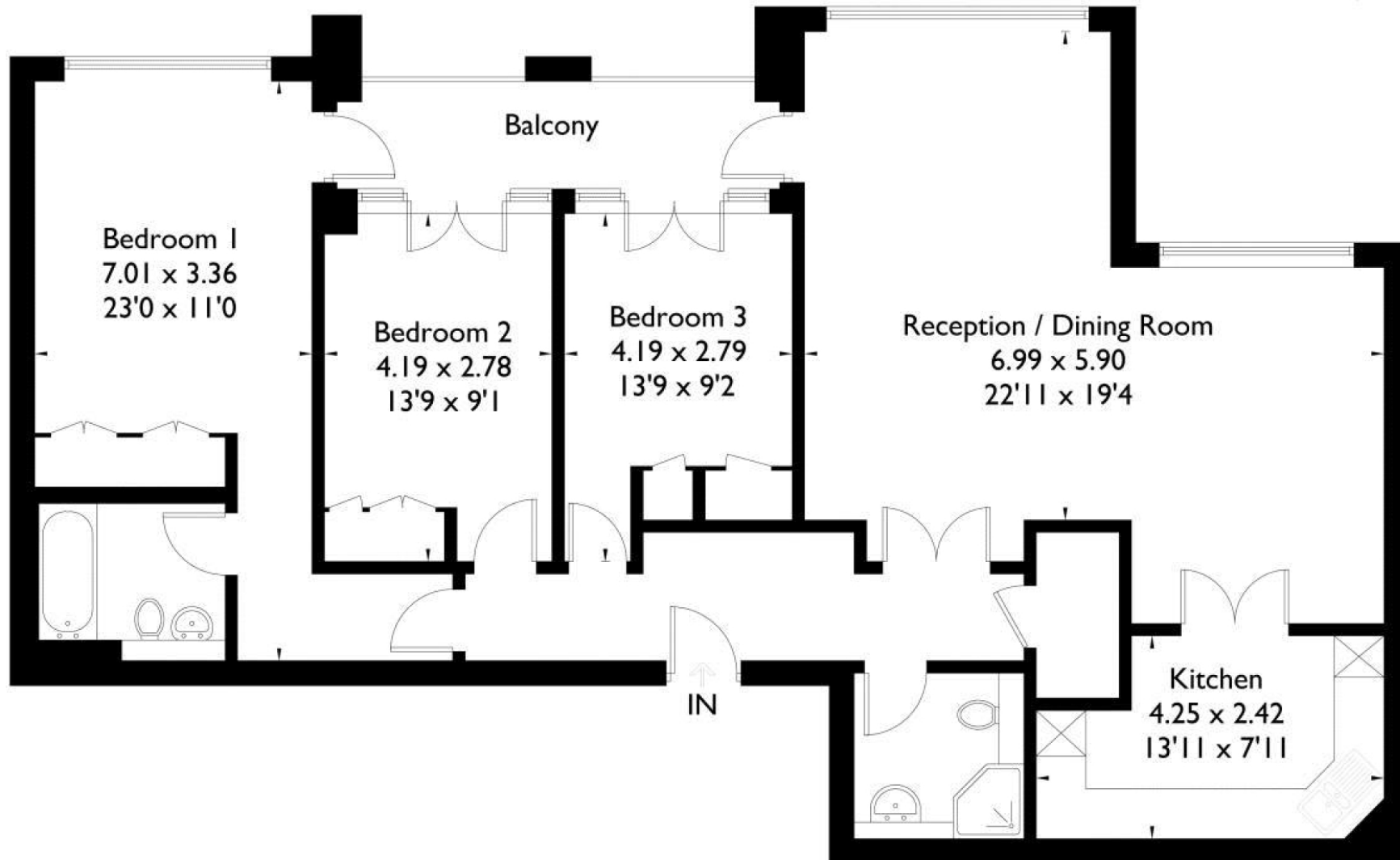

FLOORPLANZ © 2015 0845 6344080 Ref: 148576

This plan is for layout guidance only. Drawn in accordance with RICS guidelines. Not drawn to scale unless stated. Windows & door openings are approximate. Whilst every care is taken in the preparation of this plan, please check all dimensions, shapes & compass bearings before making any decisions reliant upon them.

Particulars

Property

Westfield,15 Kidderpore Avenue, Hampstead, London, NW3
£4,500

Rooms



1



2



3

Features

- Beautifully modernised throughout
- 24hr Porter, Parking and Terrace
- Gym, Jacuzzi & Swimming Pool
- Allocated underground parking

Information

Council Tax

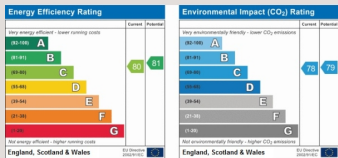

Oliver Kent

oliver.kent@vitaproperties.uk
+4477 7274 0351



Scan for our website





T: +4420 7759 2199

E: enquiries@vitaproperties.uk

Disclaimer: These particulars are prepared as a general guide for prospective purchasers or tenants and do not constitute, nor constitute part of, an offer or contract. All statements, descriptions, and measurements contained herein are given in good faith and are believed to be correct at the time of printing, but any intending purchaser or tenant should not rely on them as statements or representations of fact and must satisfy themselves by inspection or otherwise as to their correctness. Floor plans and photographs are for illustrative purposes only and may not be to scale. The position and size of doors, windows, appliances, and other features are approximate. Anti-Money Laundering (AML): In line with the Money Laundering, Terrorist Financing and Transfer of Funds Regulations 2017, we are required to carry out customer due diligence checks. Buyers/tenants will be asked to provide proof of identity, address, and source of funds before a sale or rental can be agreed. Data Protection (GDPR): Personal information supplied to Vita Properties will be processed in accordance with the General Data Protection Regulation (GDPR). Your details may be retained for legitimate business purposes relating to property services. Full details of our Privacy Policy are available on request.

All rights reserved.