



Westbere Road

LONDON, NW2

£395,000



Buy to let investors only - This superb one double bedroom apartment is located just around the corner from Kilburn tube station and walking distance to local shops and amenities.

Situated on the first floor, the flat provides lots of natural light and is complimented with its neutral decoration.

The open plan kitchen comes fully fitted with integrated appliances, including a washer/dryer, gas cooker, oven, fridge/freezer and excellent storage space, whilst the lounge also provides a dining area, making the flat perfect for a professional couple or single person.

The bedroom comes with a double bed and fitted wardrobes providing great storage space and the interlinking bathroom has a bath tub, shower, WC and sink.

Achieving £1343.33 per month - Gross yield is 4.1%









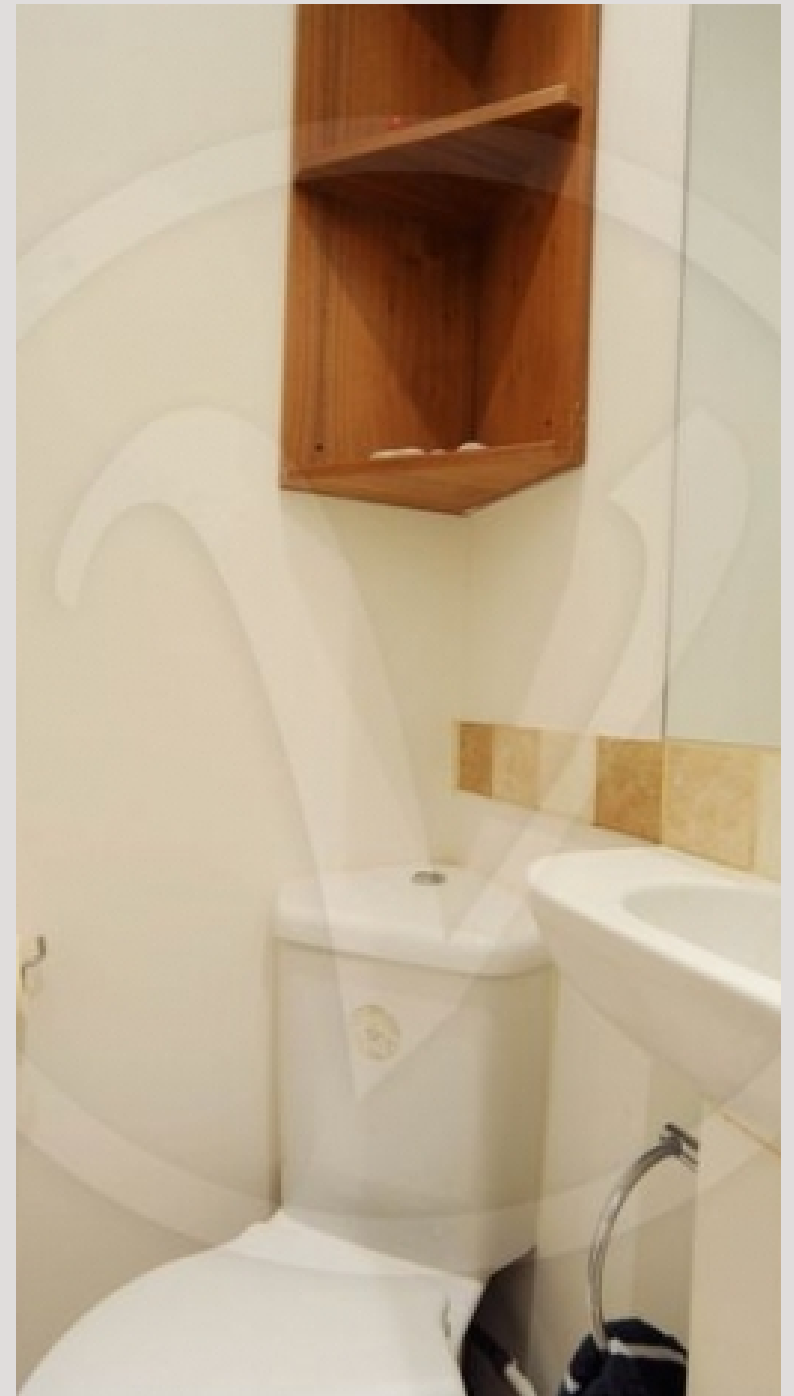

Westbere Road

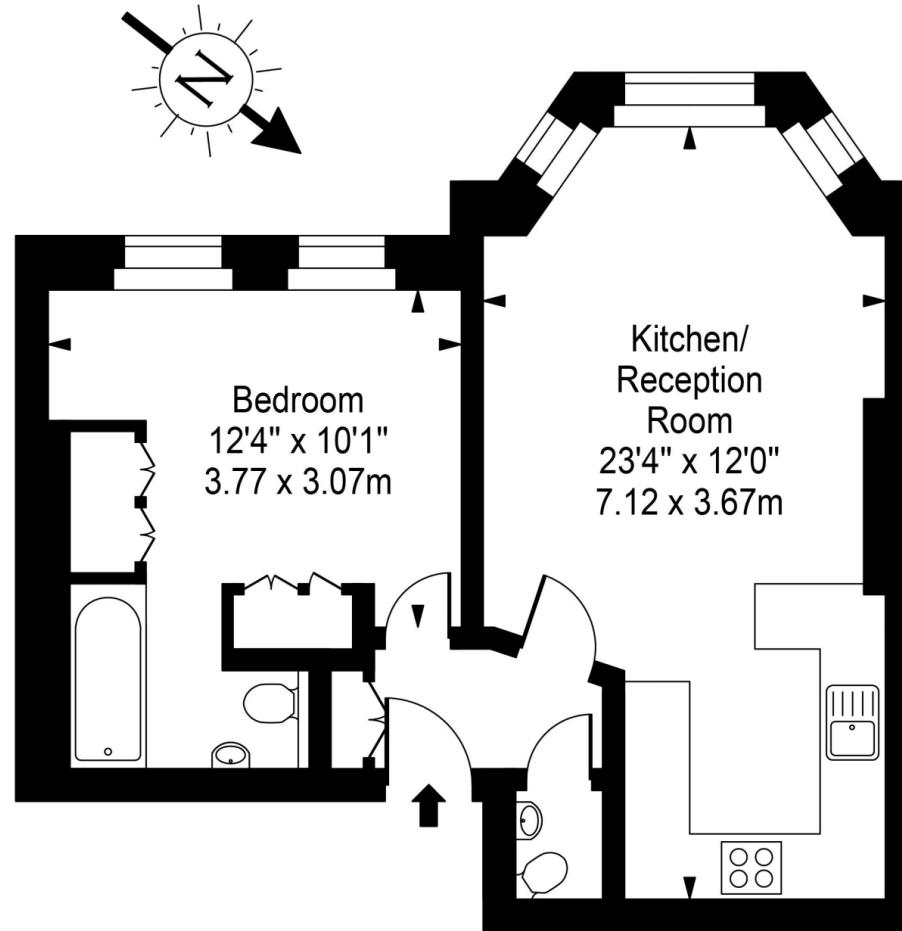

First Floor



Approx Gross Internal Area **443 Sq Ft - 41.11 Sq M**

For Illustration Purposes Only - Not To Scale
Floor plan by www.creativeplanettk.com

Particulars

Property

Westbere Road, London, NW2
£395,000

Rooms



1



1



1

Features

- Achieving £1343.33 per month - Gross yield is 4.1%
- Fitted storage
- Furnished
- Within walking to 2 train stations

Information

Council Tax

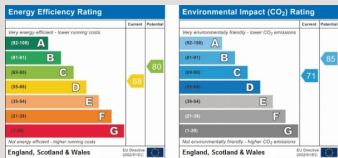

Oliver Kent

oliver.kent@vitaproperties.uk
+4477 7274 0351



Scan for our website





T: +4420 7759 2199
E: enquiries@vitaproperties.uk

Disclaimer: These particulars are prepared as a general guide for prospective purchasers or tenants and do not constitute, nor constitute part of, an offer or contract. All statements, descriptions, and measurements contained herein are given in good faith and are believed to be correct at the time of printing, but any intending purchaser or tenant should not rely on them as statements or representations of fact and must satisfy themselves by inspection or otherwise as to their correctness. Floor plans and photographs are for illustrative purposes only and may not be to scale. The position and size of doors, windows, appliances, and other features are approximate. Anti-Money Laundering (AML): In line with the Money Laundering, Terrorist Financing and Transfer of Funds Regulations 2017, we are required to carry out customer due diligence checks. Buyers/tenants will be asked to provide proof of identity, address, and source of funds before a sale or rental can be agreed. Data Protection (GDPR): Personal information supplied to Vita Properties will be processed in accordance with the General Data Protection Regulation (GDPR). Your details may be retained for legitimate business purposes relating to property services. Full details of our Privacy Policy are available on request.

All rights reserved.