



Greencroft Gardens
SOUTH HAMPSTEAD, LONDON, NW6

£779,999



Stunning first floor period conversion property in the globally sought after South Hampstead.

Property comprises two bedrooms, two bathrooms with one being an ensuite and kitchen coming off a large spacious and bright reception room.

This is an exceptional example of how beautiful character properties can be. Positioned on the first floor the proud new owner will benefit from exceptionally high ceilings and large sash windows providing an abundance of natural light.

Greencroft Gardens is by far one of the most popular roads in South Hampstead. Perfectly positioned for all the wonderful boutique shops, restaurants and bars in West Hampstead. Transport links do not get much better. Only moments from the property you will find the Jubilee Line, London Overground and Thameslink offering gateways across the City and throughout the UK





Stunning first floor period conversion property in the globally sought after South Hampstead.

Property comprises two bedrooms, two bathrooms with one being an ensuite and kitchen coming off a large spacious and bright reception room.

This is an exceptional example of how beautiful character properties can be. Positioned on the first floor the proud new owner will benefit from exceptionally high ceilings and large sash windows providing an abundance of natural light.

Greencroft Gardens is by far one of the most popular roads in South Hampstead. Perfectly positioned for all the wonderful boutique shops, restaurants and bars in West Hampstead. Transport links do not get much better. Only moments from the property you will find the Jubilee Line, London Overground and Thameslink offering gateways across the City and throughout the UK









Greencroft Gardens

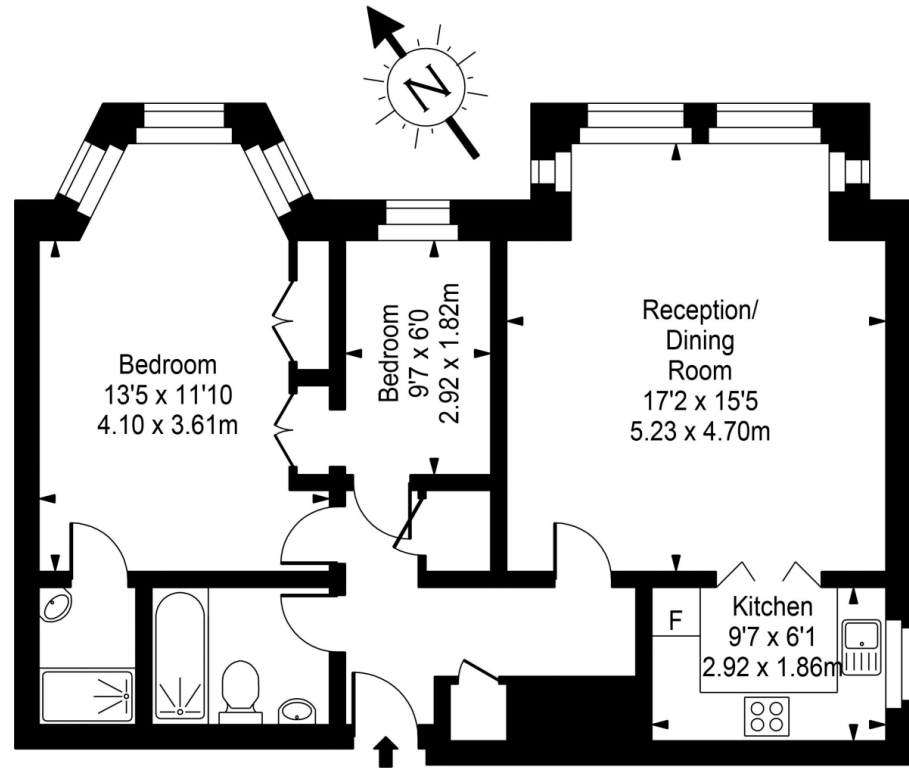

First Floor



Approx Gross Internal Area **741 Sq Ft - 68.84 Sq M**

For Illustration Purposes Only - Not To Scale
Floor plan by www.bestangle.co.uk

Particulars

Property

Greencroft Gardens, South Hampstead, London, NW6
£779,999

Rooms



1



2



2

Features

- Large reception room
- First floor
- Two bed Two bath
- Moment to West Hampstead and Finchley Road amenities

Information

Council Tax

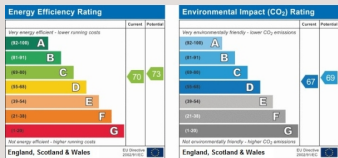

Oliver Kent

oliver.kent@vitaproperties.uk
+4477 7274 0351



Scan for our website





T: +4420 7759 2199

E: enquiries@vitaproperties.uk

Disclaimer: These particulars are prepared as a general guide for prospective purchasers or tenants and do not constitute, nor constitute part of, an offer or contract. All statements, descriptions, and measurements contained herein are given in good faith and are believed to be correct at the time of printing, but any intending purchaser or tenant should not rely on them as statements or representations of fact and must satisfy themselves by inspection or otherwise as to their correctness. Floor plans and photographs are for illustrative purposes only and may not be to scale. The position and size of doors, windows, appliances, and other features are approximate. Anti-Money Laundering (AML): In line with the Money Laundering, Terrorist Financing and Transfer of Funds Regulations 2017, we are required to carry out customer due diligence checks. Buyers/tenants will be asked to provide proof of identity, address, and source of funds before a sale or rental can be agreed. Data Protection (GDPR): Personal information supplied to Vita Properties will be processed in accordance with the General Data Protection Regulation (GDPR). Your details may be retained for legitimate business purposes relating to property services. Full details of our Privacy Policy are available on request.

All rights reserved.