



Pembridge Crescent
NOTTING HILL, LONDON, W11

£595



Available immediately and offering a luxurious finish, this gorgeous two bedroomed flat offers en suite facilities for the master bedroom, plenty of vault storage space and a superb location in the heat of Notting Hill Gate.

The property comprises an impressive reception room with dining space and fitted kitchen, master bedroom with en suite bathroom, second bedroom with en suite bathroom and private terrace.

Pembridge Crescent is within a short walk from Notting Hill tube station (Central, Circle and District lines), which provides an easy commute to the City and other parts of central London





Available immediately and offering a luxurious finish, this gorgeous two bedroomed flat offers en suite facilities for the master bedroom, plenty of vault storage space and a superb location in the heat of Notting Hill Gate.

The property comprises an impressive reception room with dining space and fitted kitchen, master bedroom with en suite bathroom, second bedroom with en suite bathroom and private terrace.

Pembridge Crescent is within a short walk from Notting Hill tube station (Central, Circle and District lines), which provides an easy commute to the City and other parts of central London









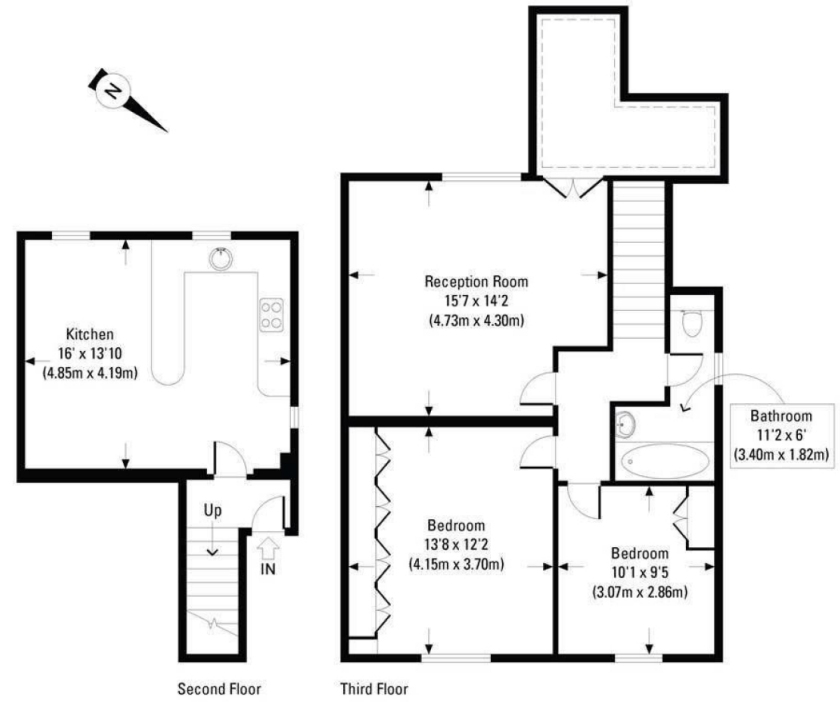

Approx. Gross Internal Floor Area 866 Sq. Ft. / 80.49 Sq. M. (Excluding Restricted Height Area)

Floor plans are for illustrative purposes only and not to scale.

Compliant with RICS code of measuring practice.

Particulars

Property

Pembridge Crescent, Notting Hill, London, W11
£595

Rooms



Features

- Short walk from Notting Hill tube station (Central, Circle and District lines)
- Moments from boutiques, bars and restaurants of Westbourne Grove
- Eat in Kitchen
- Spacious reception

Information

Council Tax



Oliver Kent

oliver.kent@vitaproperties.uk
+4477 7274 0351



Scan for our website





T: +4420 7759 2199
E: enquiries@vitaproperties.uk

Disclaimer: These particulars are prepared as a general guide for prospective purchasers or tenants and do not constitute, nor constitute part of, an offer or contract. All statements, descriptions, and measurements contained herein are given in good faith and are believed to be correct at the time of printing, but any intending purchaser or tenant should not rely on them as statements or representations of fact and must satisfy themselves by inspection or otherwise as to their correctness. Floor plans and photographs are for illustrative purposes only and may not be to scale. The position and size of doors, windows, appliances, and other features are approximate. Anti-Money Laundering (AML): In line with the Money Laundering, Terrorist Financing and Transfer of Funds Regulations 2017, we are required to carry out customer due diligence checks. Buyers/tenants will be asked to provide proof of identity, address, and source of funds before a sale or rental can be agreed. Data Protection (GDPR): Personal information supplied to Vita Properties will be processed in accordance with the General Data Protection Regulation (GDPR). Your details may be retained for legitimate business purposes relating to property services. Full details of our Privacy Policy are available on request.

All rights reserved.