



Arkwright Road
HAMPSTEAD , LONDON, NW3

£6,000



We are excited to bring to the market this fully extended 3 bedroom, 3 bathroom apartment set within moments of Hampstead Village. Being totally renovated this modern apartment has been interior designed and offers 3 large double bedrooms, 2 fully tiled ensuite's and a guest bathroom, wooden floors, a stunning large reception room with retracting doors opening on to a decked terrace and leading down to a private lawned garden, a fully fitted open plan kitchen, guest wc with utility area and 1 allocated off street parking space.

Arkwright Road is located just off Finchley Road and Fitzjohns Avenue offering easy access to all the surrounding areas including the northern line and Finchley's road overland, Jubilee and Metropolitan train lines, it is also within close proximity to the M1 and the centre of London.





We are excited to bring to the market this fully extended 3 bedroom, 3 bathroom apartment set within moments of Hampstead Village. Being totally renovated this modern apartment has been interior designed and offers 3 large double bedrooms, 2 fully tiled ensuite's and a guest bathroom, wooden floors, a stunning large reception room with retracting doors opening on to a decked terrace and leading down to a private lawned garden, a fully fitted open plan kitchen, guest wc with utility area and 1 allocated off street parking space.

Arkwright Road is located just off Finchley Road and Fitzjohns Avenue offering easy access to all the surrounding areas including the northern line and Finchley's road overland, Jubilee and Metropolitan train lines, it is also within close proximity to the M1 and the centre of London.









Scan for out video walkthrough

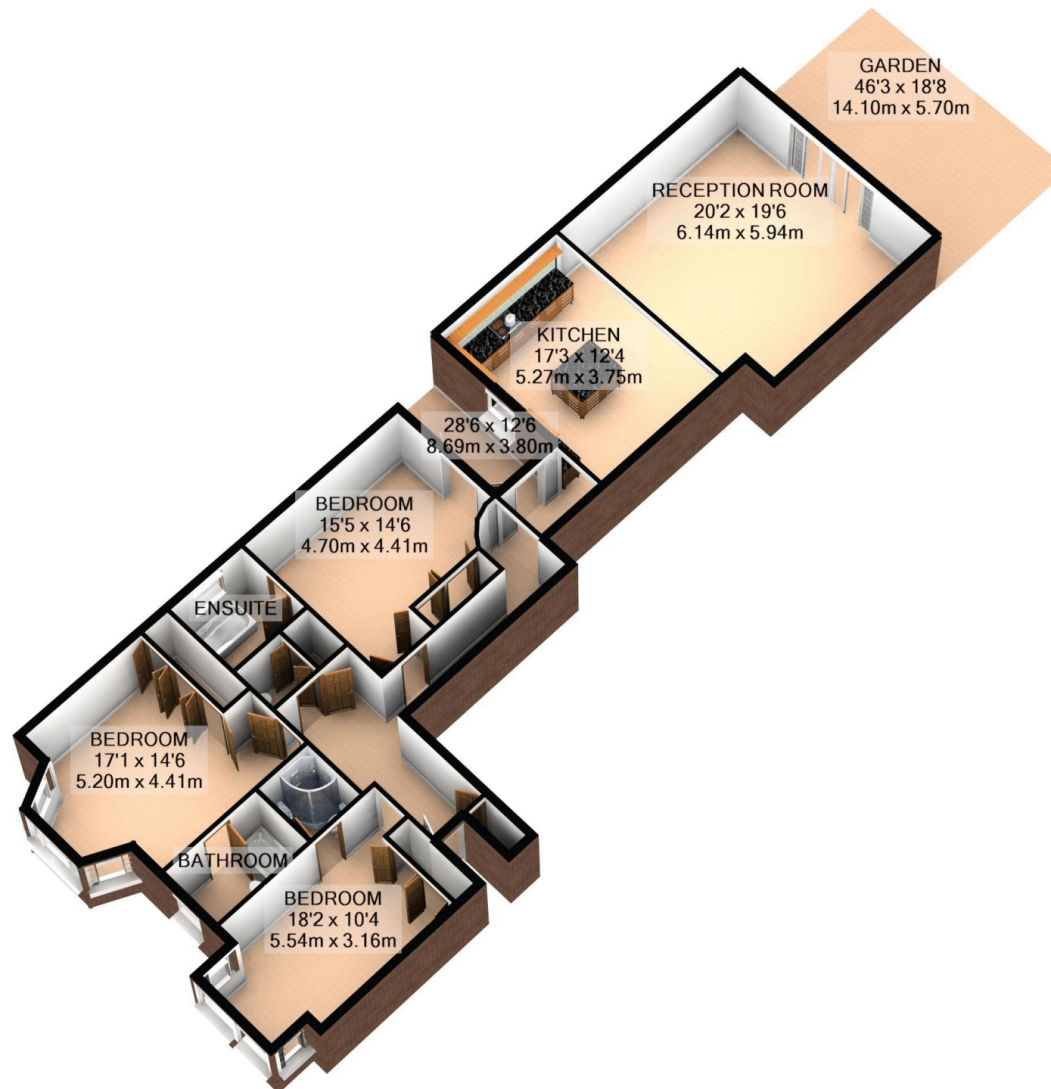

Total Approx. Floor Area 1557 Sq.Ft. (144.6 Sq.M.)

KeyAGENT LTD Floor Plans are produced and provided for illustration purposes only. Whilst every attempt has been made to ensure the plan is accurate and presents the property in the best way, measurements of doors, windows and rooms are approximate and no responsibility is taken for any error, omission or mis-statement. To find out more about KeyAGENT please visit www.keyagent.co.uk (Tel: 0845 475 4165)
Made with Metropix ©2012

Particulars

Property

Arkwright Road, Hampstead , London, NW3
£6,000

Rooms

 1

 3

 3

Features

- 3 Large Double Bedrooms
- 3 Bathrooms
- Early Viewings Recommended
- Council tax - F - £1908 per annum

Information

Council Tax

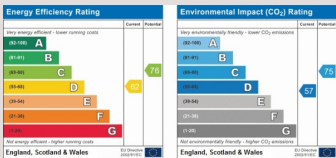

Oliver Kent
oliver.kent@vitaproperties.uk
+4477 7274 0351



Scan for our website





T: +4420 7759 2199
E: enquiries@vitaproperties.uk

Disclaimer: These particulars are prepared as a general guide for prospective purchasers or tenants and do not constitute, nor constitute part of, an offer or contract. All statements, descriptions, and measurements contained herein are given in good faith and are believed to be correct at the time of printing, but any intending purchaser or tenant should not rely on them as statements or representations of fact and must satisfy themselves by inspection or otherwise as to their correctness. Floor plans and photographs are for illustrative purposes only and may not be to scale. The position and size of doors, windows, appliances, and other features are approximate. Anti-Money Laundering (AML): In line with the Money Laundering, Terrorist Financing and Transfer of Funds Regulations 2017, we are required to carry out customer due diligence checks. Buyers/tenants will be asked to provide proof of identity, address, and source of funds before a sale or rental can be agreed. Data Protection (GDPR): Personal information supplied to Vita Properties will be processed in accordance with the General Data Protection Regulation (GDPR). Your details may be retained for legitimate business purposes relating to property services. Full details of our Privacy Policy are available on request.

All rights reserved.