



**VITA**  
*Properties*

Cranfield Court, Homer Street, London W1H 4NF | £2,850

- Furnished
- Bright
- Fantastic Location
- Close to Tube

- Close to Park
- Close to High Streets, Restaurants and Cafe's

"Vita Properties have been tremendously helpful throughout the process of securing/renting my flat. Informative about the property, prompt communication, easy to use dashboard for sharing of information, and pleasant to work with. Highly recommend!"

---

Situated in the highly sought-after Cranfield Court, this modern one-bedroom apartment offers a stylish living space in the heart of London. Designed to cater to the needs of urban dwellers, the property combines sleek finishes with functional living spaces, making it an ideal choice for professionals or couples seeking a comfortable, well-located home.





Upon entering the flat, you are greeted by a bright and spacious reception area. This versatile space is perfect for both relaxing and entertaining, thanks to its ample room for seating and dining arrangements. Large windows allow natural light to flood in, creating an inviting atmosphere throughout the day.

The bedroom is well-proportioned and provides a peaceful retreat after a busy day in the city. With enough space to comfortably accommodate a double bed and storage furniture, it offers a practical yet cosy environment. Neutral décor and modern fittings contribute to a clean and contemporary aesthetic.

The kitchen is designed with functionality in mind, offering a range of integrated appliances alongside ample cupboard and worktop space. Sleek cabinetry and quality finishes make it both stylish and practical for everyday use.

The bathroom is equally impressive, featuring modern fixtures and a tasteful design. It includes a full-size bathtub with overhead shower, a washbasin, and a toilet, all complemented by elegant tiling and well-placed lighting.

Cranfield Court is known for its excellent location, providing easy access to a variety of local amenities, shops, and dining options. Furthermore, public transport links are abundant, ensuring quick and convenient travel across London.

-  Apartment
-  Under Offer
-  x 1
-  x 1
-  x 1

SCAN FOR  
A VIDEO  
WALKTHROUGH



Oliver Kent

 [oliver.kent@vitaproperties.uk](mailto:oliver.kent@vitaproperties.uk)  
 +4477 7274 0351



"I was very impressed with Vita and their network of buyers. When the sale of my flat fell through (twice) they worked extremely hard to find new buyers in a difficult market - thank you!"

---



"Working with Vita properties has been a smooth experience! No complaints at all. Our letting agent, Diana has been fantastic and very helpful throughout the whole process. I would highly recommend both Vita properties and Diana."

---



"I used Vita properties to find a flat recently and it was an overall professional, personalised and positive experience. Saira went the extra mile to accommodate to our needs and quick to help us whenever possible."

---



MORE INFO, PICTURES,  
CONTACT ON  
OUR WEBSITE



"Vita Properties is a very professional agency. My experience with them was incredible and the entire team was very helpful and kind throughout the renting process. I'd highly recommend!"

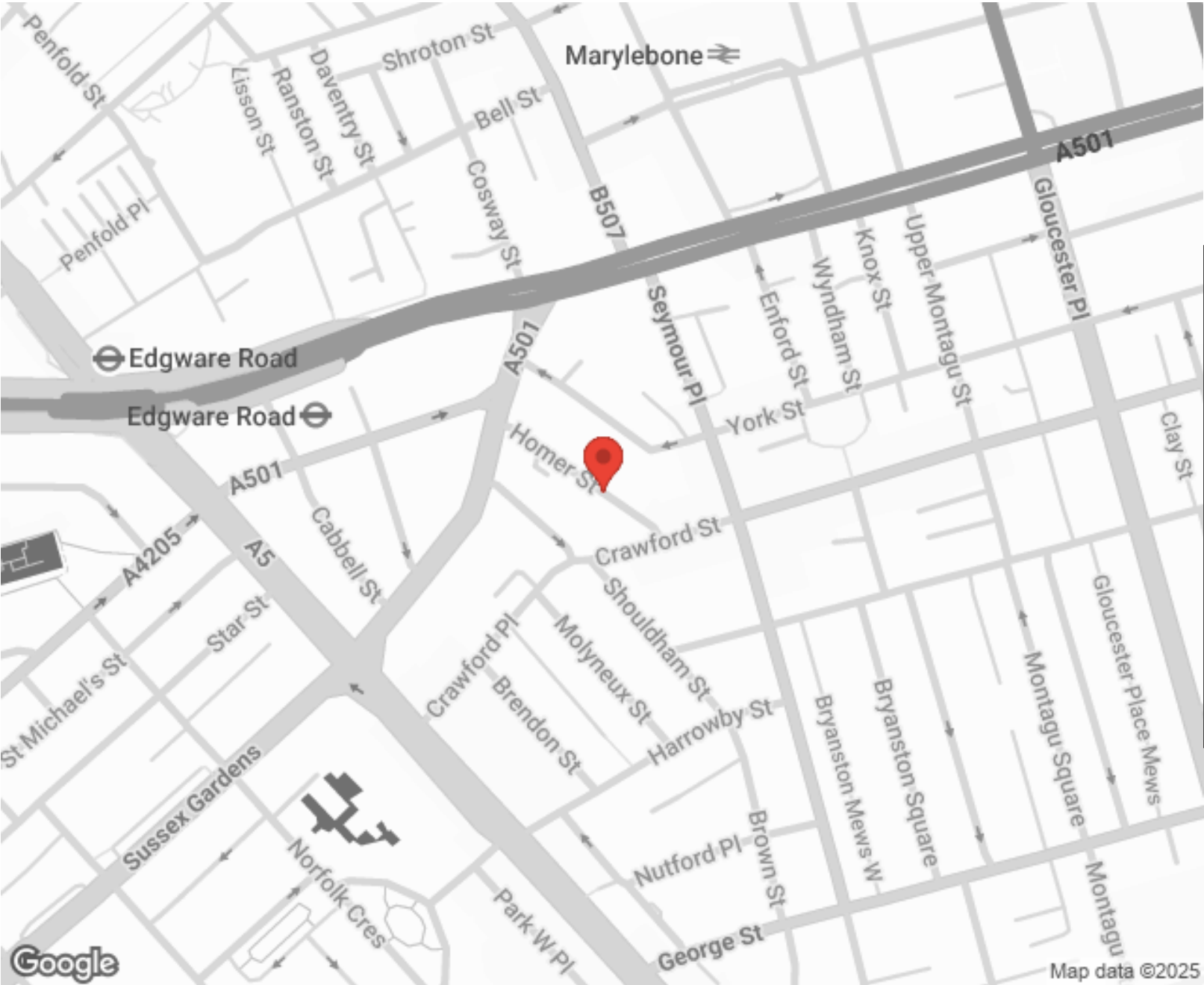

Energy rating and score

This property's current energy rating is C. It has the potential to be C.  
[See how to improve this property's energy efficiency.](#)

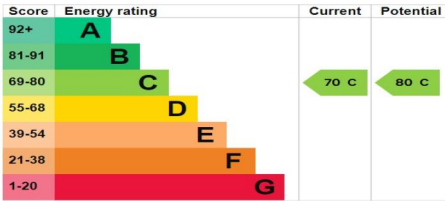

The graph shows this property's current and potential energy rating.

SCAN FOR MORE  
GOOGLE REVIEWS



Google



4.9 Stars | 132 Reviews

Find us on social media

- vitaproperties
- VitaProperties
- VitaProperties

# Cranfield Court, W1H



Approximate Gross Internal Area = 456 sq ft / 42.4 sq m

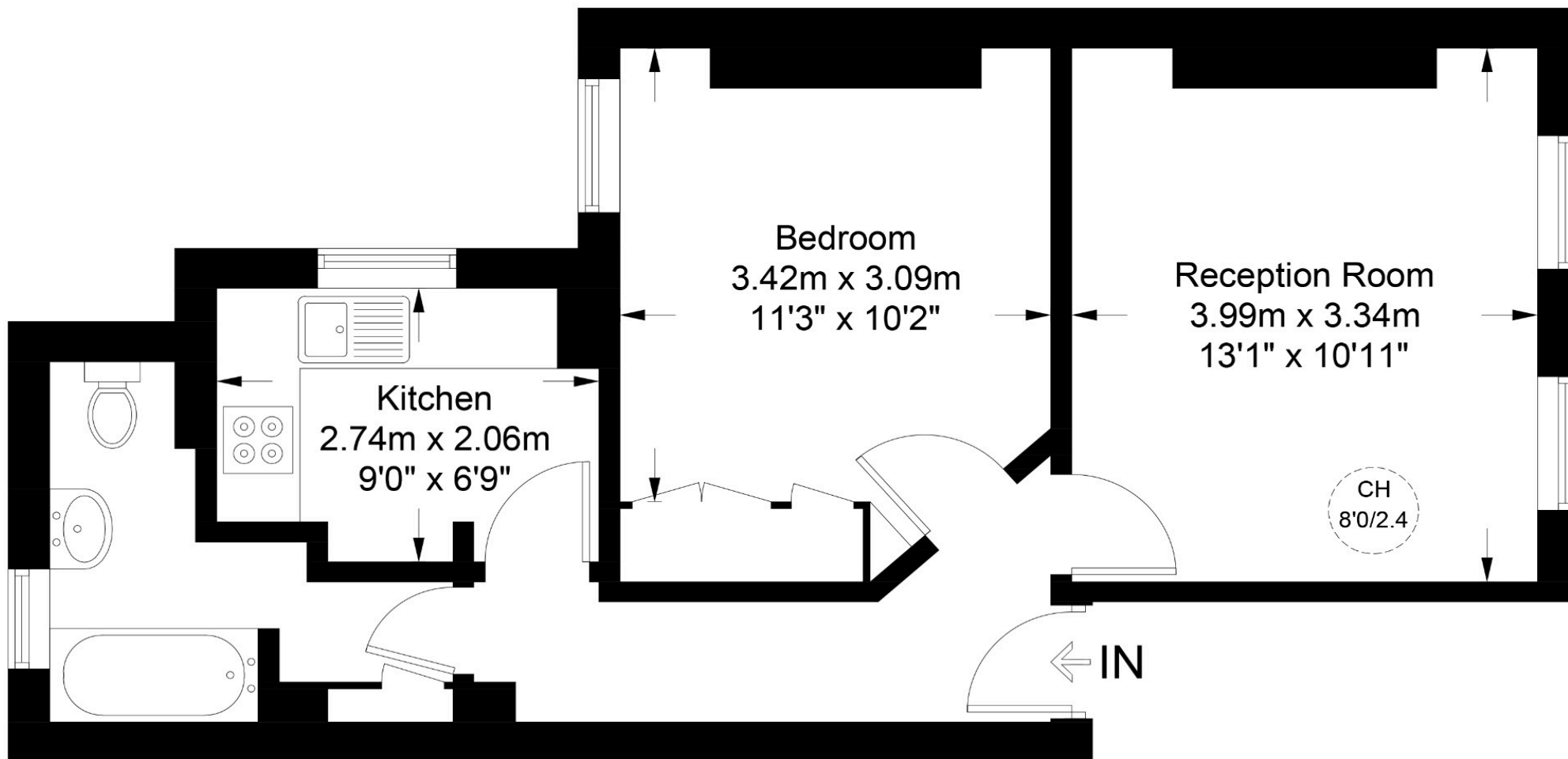

## Second Floor



**Certified  
Property  
Measurer**

This plan is for layout guidance only. Not drawn to scale unless stated. Windows and door openings are approximate. Whilst every care is taken in the preparation of this plan, please check all dimensions, shapes and compass bearings before making any decisions reliant upon them. (ID981815)