



**VITA**  
*Properties*

Northways, College Crescent, Swiss Cottage, London NW3 | £575

- Furnished
- Wooden Floors
- Seconds to Swiss Cottage Tube
- Two double bedrooms

- Double Glazed
- Heating & Hot Water Included in the rent

"Vita Properties have been tremendously helpful throughout the process of securing/renting my flat. Informative about the property, prompt communication, easy to use dashboard for sharing of information, and pleasant to work with. Highly recommend!"

---

Available immediately – This modern 2-bedroom flat is located in the sought-after Swiss Cottage neighborhood of London and is available for rent. As you enter the property, you will be greeted by a bright and inviting living room that is perfect for relaxing and entertaining. The living room is equipped with large windows that provide plenty of natural light, as well as beautiful hardwood floors that add to the character of the space. The flat features a fitted separate kitchen, fully fitted with modern appliances and ample storage, ideal for home cooking. The bedroom is well-proportioned, comfortably fitting a double bed and has large windows that allow plenty of natural light to shine through. The bathroom is modern and well-maintained, with a shower over the bathtub. The flat is located on a quiet tree-lined street, just a short walk from all the amenities it offers. It's also only a stone's throw away from the tube station, which offers a quick access to Central London and other parts of the city. With its prime location, well-appointed interior, and peaceful

phere, this flat is the ideal home for anyone looking to rent in the Swiss Cottage area. Hot Water and Heating Included – Offered on a Furnished basis





Flat



Under Negotiation



x 2



x 1



x 1





"I was very impressed with Vita and their network of buyers. When the sale of my flat fell through (twice) they worked extremely hard to find new buyers in a difficult market - thank you!"

---



"Working with Vita properties has been a smooth experience! No complaints at all. Our letting agent, Diana has been fantastic and very helpful throughout the whole process. I would highly recommend both Vita properties and Diana."

---





"I used Vita properties to find a flat recently and it was an overall professional, personalised and positive experience. Saira went the extra mile to accommodate to our needs and quick to help us whenever possible."

---



**MORE INFO, PICTURES,  
CONTACT ON  
OUR WEBSITE**



"Vita Properties is a very professional agency. My experience with them was incredible and the entire team was very helpful and kind throughout the renting process. I'd highly recommend!"

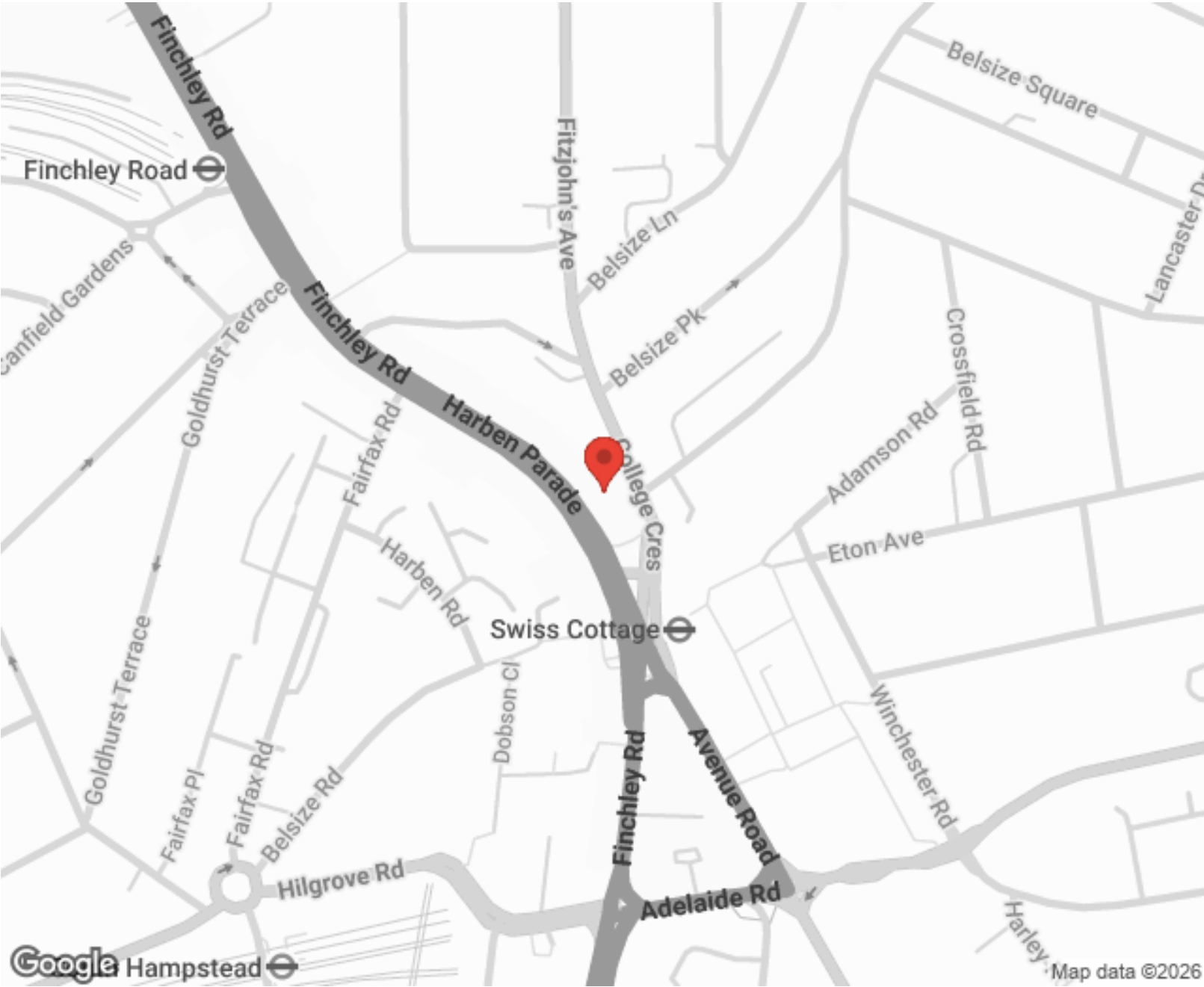

Energy efficiency rating for this property

This property's current energy rating is C. It has the potential to be B.

[See how to improve this property's energy performance.](#)

Score	Energy rating	Current	Potential
92+	A		
81-91	B		82   B
69-80	C	79   C	
55-68	D		
39-54	E		
21-38	F		
1-20	G		

SCAN FOR MORE  
GOOGLE REVIEWS



Google



4.9 Stars | 132 Reviews

Find us on social media



vitaproperties



VitaProperties



VitaProperties



# Northways College, Crescent, NW3

Approximate Gross Internal Area = 751 sq ft / 69.8 sq m

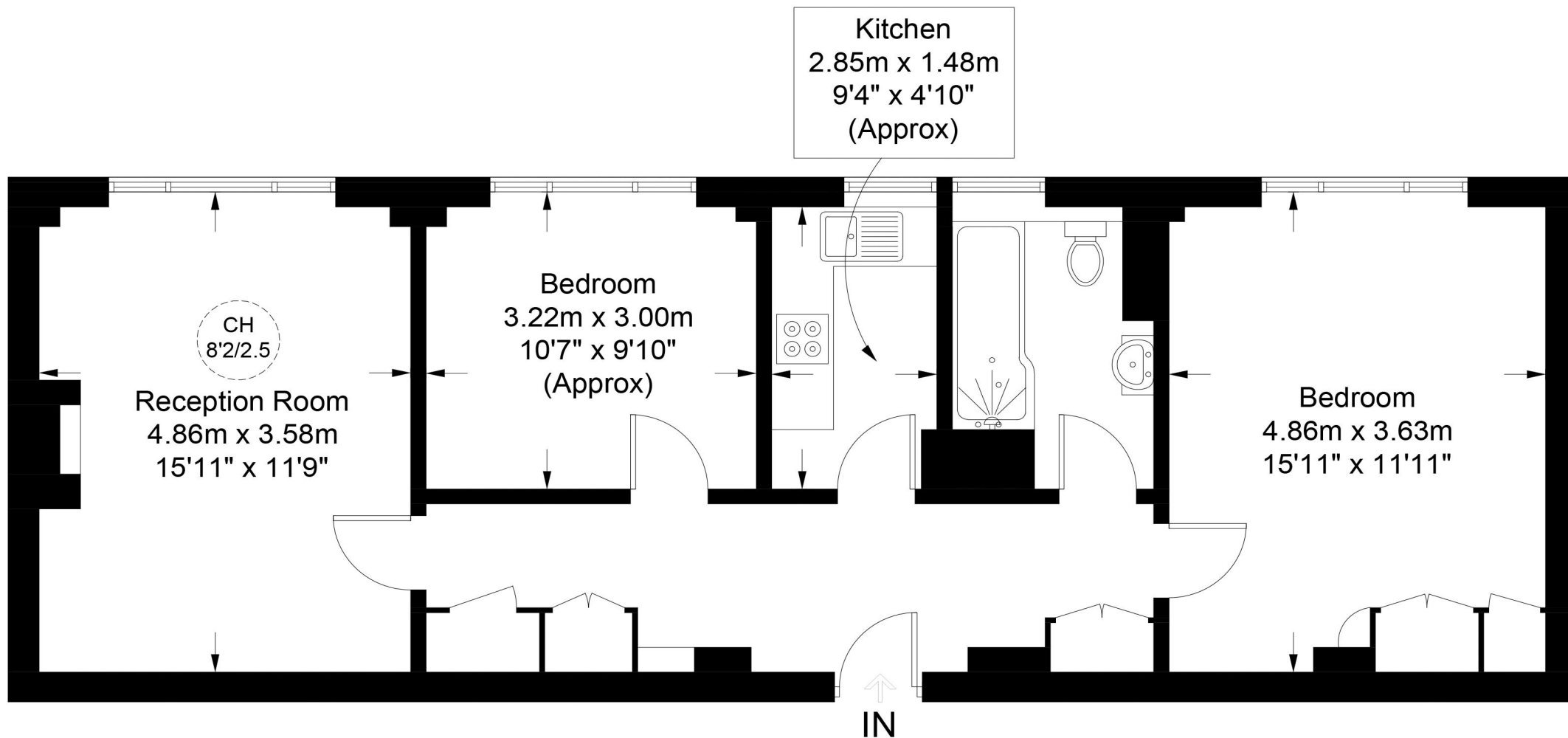

## First Floor



**Certified  
Property  
Measurer**

This plan is for layout guidance only. Not drawn to scale unless stated. Windows and door openings are approximate. Whilst every care is taken in the preparation of this plan, please check all dimensions, shapes and compass bearings before making any decisions reliant upon them. (ID932840)