



Pembridge Crescent, Notting Hill, London, W11 .| £595

- Short walk from Notting Hill tube station (Central, Circle and District lines)
- Moments from boutiques, bars and restaurants of Westbourne Grove
- Eat in Kitchen
- Spacious reception
- Two bed - Two bath - (can be used as a 3 bed)
- Available immediately

"Vita Properties have been tremendously helpful throughout the process of securing/renting my flat. Informative about the property, prompt communication, easy to use dashboard for sharing of information, and pleasant to work with. Highly recommend!"

Available immediately and offering a luxurious finish, this gorgeous two bedroomed flat offers en suite facilities for the master bedroom, plenty of vault storage space and a superb location in the heart of Notting Hill Gate. The property comprises an impressive reception room with dining space and fitted kitchen, master bedroom with en suite bathroom, second bedroom with en suite bathroom and private terrace.

Pembridge Crescent is within a short walk from Notting Hill tube station (Central, Circle and District lines), which provides an easy commute to the City and other parts of central London



Oliver Kent

✉ oliver.kent@vitaproperties.uk
☎ +4477 7274 0351



🏠 Flat
🔑 Available
to Let
🛏 x 2
🛏 x 1
🚿 x 1



"I was very impressed with Vita and their network of buyers. When the sale of my flat fell through (twice) they worked extremely hard to find new buyers in a difficult market - thank you!"



"Working with Vita properties has been a smooth experience! No complaints at all. Our letting agent, Diana has been fantastic and very helpful throughout the whole process. I would highly recommend both Vita properties and Diana."



"I used Vita properties to find a flat recently and it was an overall professional, personalised and positive experience. Saira went the extra mile to accommodate to our needs and quick to help us whenever possible."



**MORE INFO, PICTURES,
CONTACT ON
OUR WEBSITE**



"Vita Properties is a very professional agency. My experience with them was incredible and the entire team was very helpful and kind throughout the renting process. I'd highly recommend!"

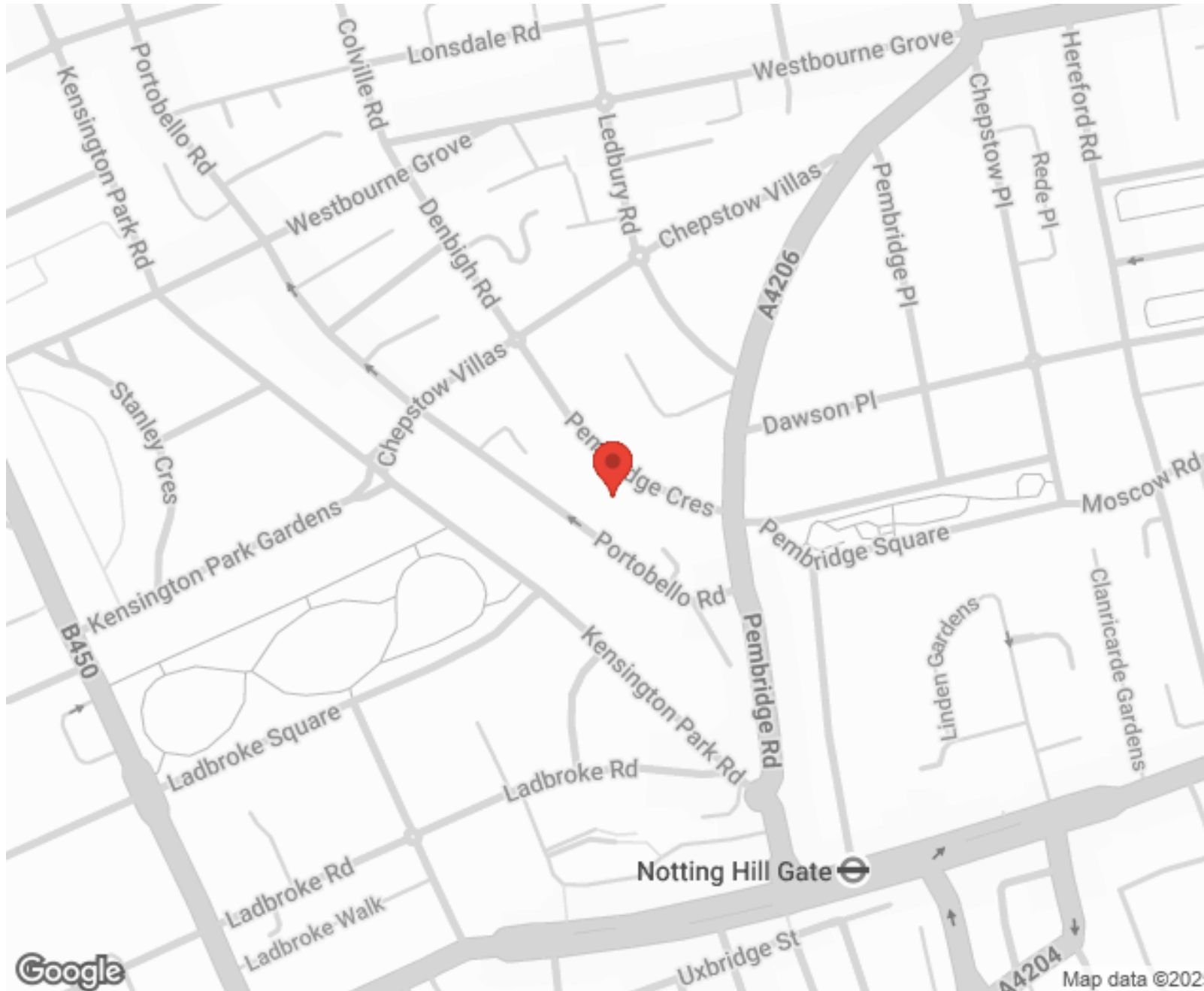

SCAN FOR MORE
GOOGLE REVIEWS



Google



4.9 Stars | 132 Reviews

Find us on social media

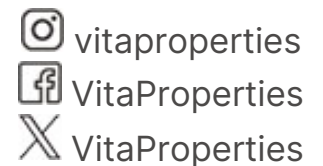

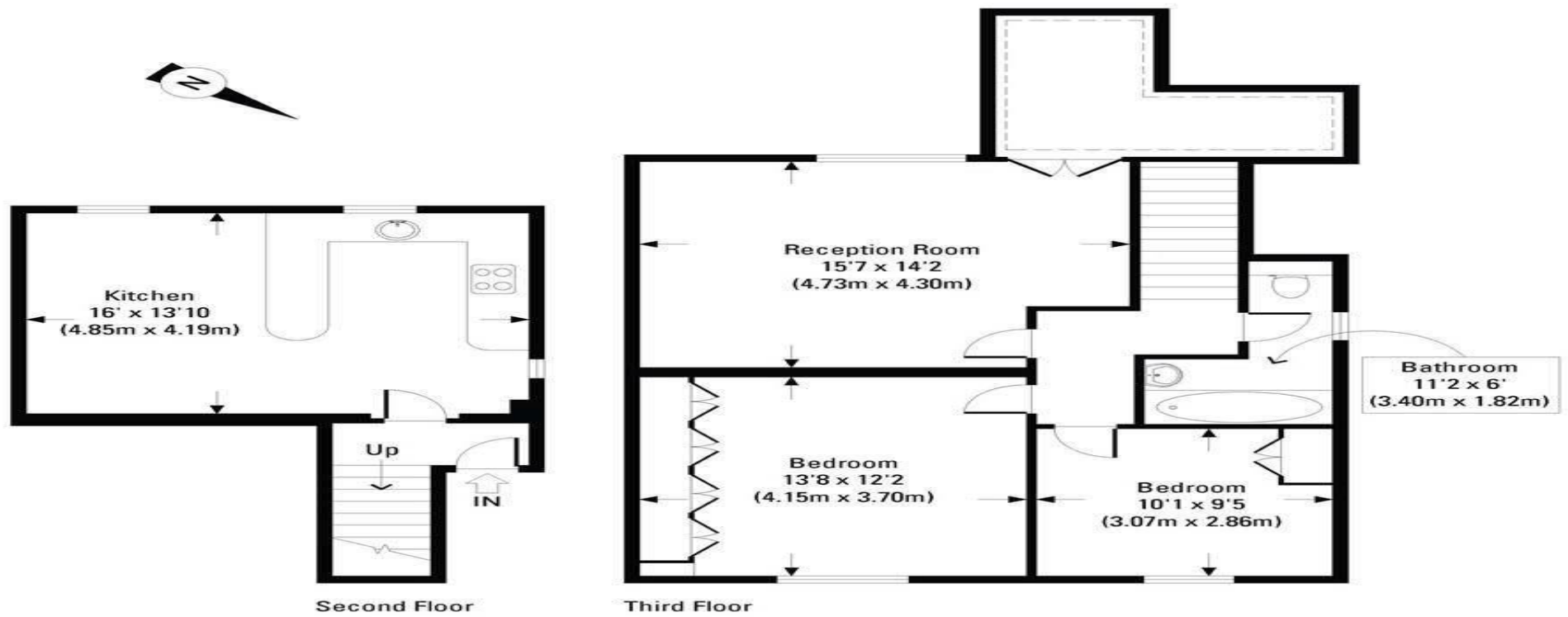

Approx. Gross Internal Floor Area 866 Sq. Ft. / 80.49 Sq. M. (Excluding Restricted Height Area)
 Floor plans are for illustrative purposes only and not to scale.
 Compliant with RICS code of measuring practice.