



**VITA**  
*Properties*

Oak Hill Park, Hampstead, London, NW3 | £1,475,000

- Stunning views
- Portered block
- First come first serve parking
- Two private balconies

- Share Of Freehold
- No upper chain
- Two bathrooms
- Moments to Hampstead Village

"Vita Properties have been tremendously helpful throughout the process of securing/renting my flat. Informative about the property, prompt communication, easy to use dashboard for sharing of information, and pleasant to work with. Highly recommend!"

---

Having undergone a full refurbishment we are delighted to bring back to the market this superb opportunity to acquire this three bedroom two bathroom (1,244 sq ft) apartment situated on the fourth floor of a portered purpose built block in the heart of Hampstead Village.

Northwood Lodge forms part of the Oak Hill Park development, which is discreetly positioned off Frognal and set within beautiful landscaped communal grounds with resident's tennis court. The fashionable cafés and boutiques of Hampstead Village and the green open spaces of Hampstead Heath are also within reach.

This property has fantastic views toward woodlands and offers exceptionally bright living space featuring a double reception/dining room, a semi open-plan fitted kitchen, a spacious principal bedroom suite with en-suite shower room, second double bedroom, third bedroom and a family bathroom.

Further benefits include Share Of Freehold, lift in block, first come first serve parking, two private balconies and no upper chain.



Oliver Kent

✉ [oliver.kent@vitaproperties.uk](mailto:oliver.kent@vitaproperties.uk)

☎ +4477 7274 0351



"I was very impressed with Vita and their network of buyers. When the sale of my flat fell through (twice) they worked extremely hard to find new buyers in a difficult market - thank you!"

---



"Working with Vita properties has been a smooth experience! No complaints at all. Our letting agent, Diana has been fantastic and very helpful throughout the whole process. I would highly recommend both Vita properties and Diana."

---





"I used Vita properties to find a flat recently and it was an overall professional, personalised and positive experience. Saira went the extra mile to accommodate to our needs and quick to help us whenever possible."

---



**MORE INFO, PICTURES,  
CONTACT ON  
OUR WEBSITE**



"Vita Properties is a very professional agency. My experience with them was incredible and the entire team was very helpful and kind throughout the renting process. I'd highly recommend!"

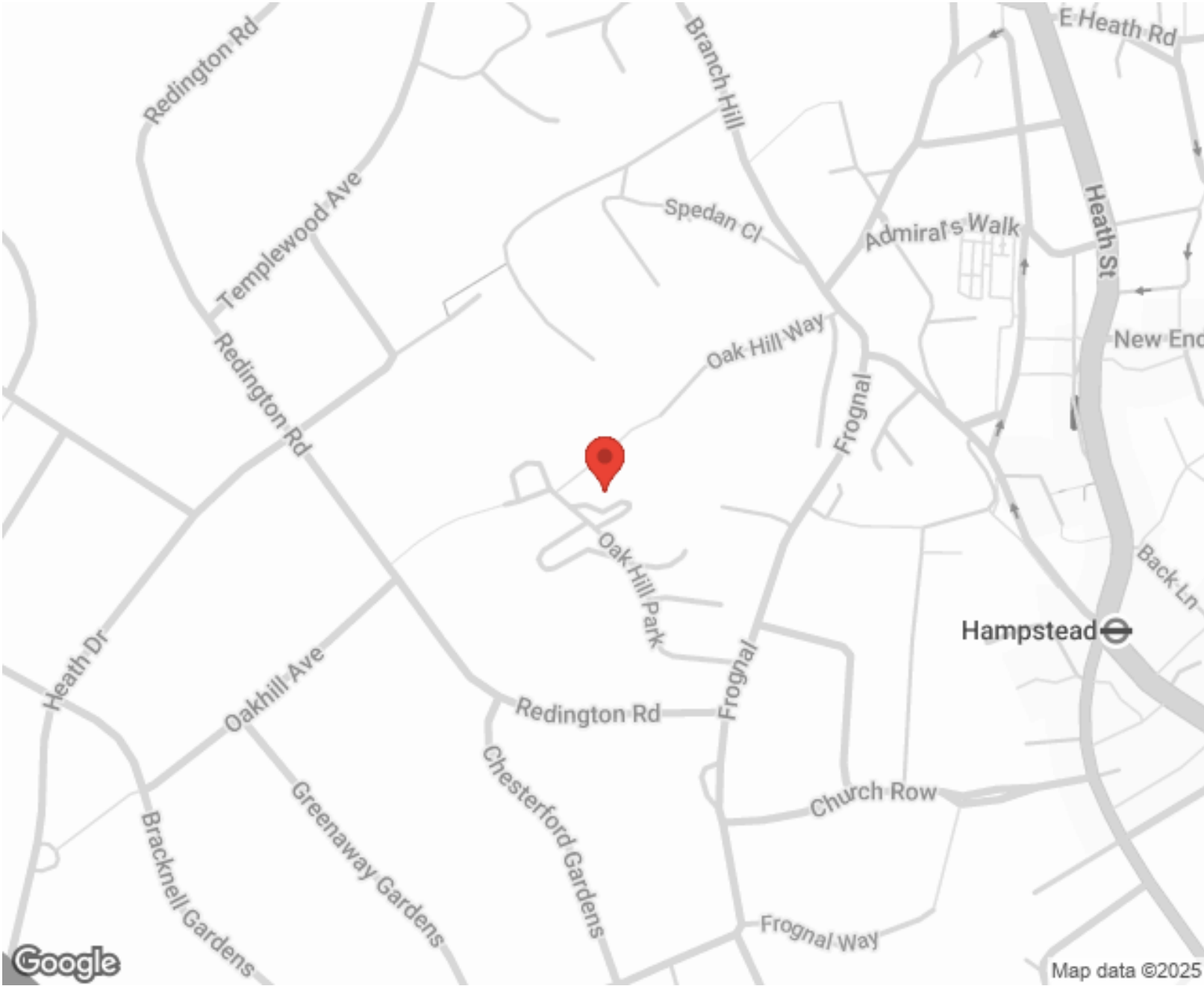

Energy Efficiency Rating			Environmental Impact (CO <sub>2</sub> ) Rating		
	Current	Potential		Current	Potential
Very energy efficient - lower running costs			Very environmentally friendly - lower CO <sub>2</sub> emissions		
(92-100) <b>A</b>			(92-100) <b>A</b>		
(81-91) <b>B</b>			(81-91) <b>B</b>		
(69-80) <b>C</b>			(69-80) <b>C</b>		
(55-68) <b>D</b>			(55-68) <b>D</b>		
(39-54) <b>E</b>			(39-54) <b>E</b>		
(21-38) <b>F</b>			(21-38) <b>F</b>		
(1-20) <b>G</b>			(1-20) <b>G</b>		
Not energy efficient - higher running costs			Not environmentally friendly - higher CO <sub>2</sub> emissions		
England, Scotland & Wales			England, Scotland & Wales		
EU Directive			EU Directive		

SCAN FOR MORE  
GOOGLE REVIEWS

Google  
★★★★★  
4.9 Stars | 132 Reviews

Find us on social media

vitaproperties  
 VitaProperties  
 VitaProperties

## Northwood Lodge

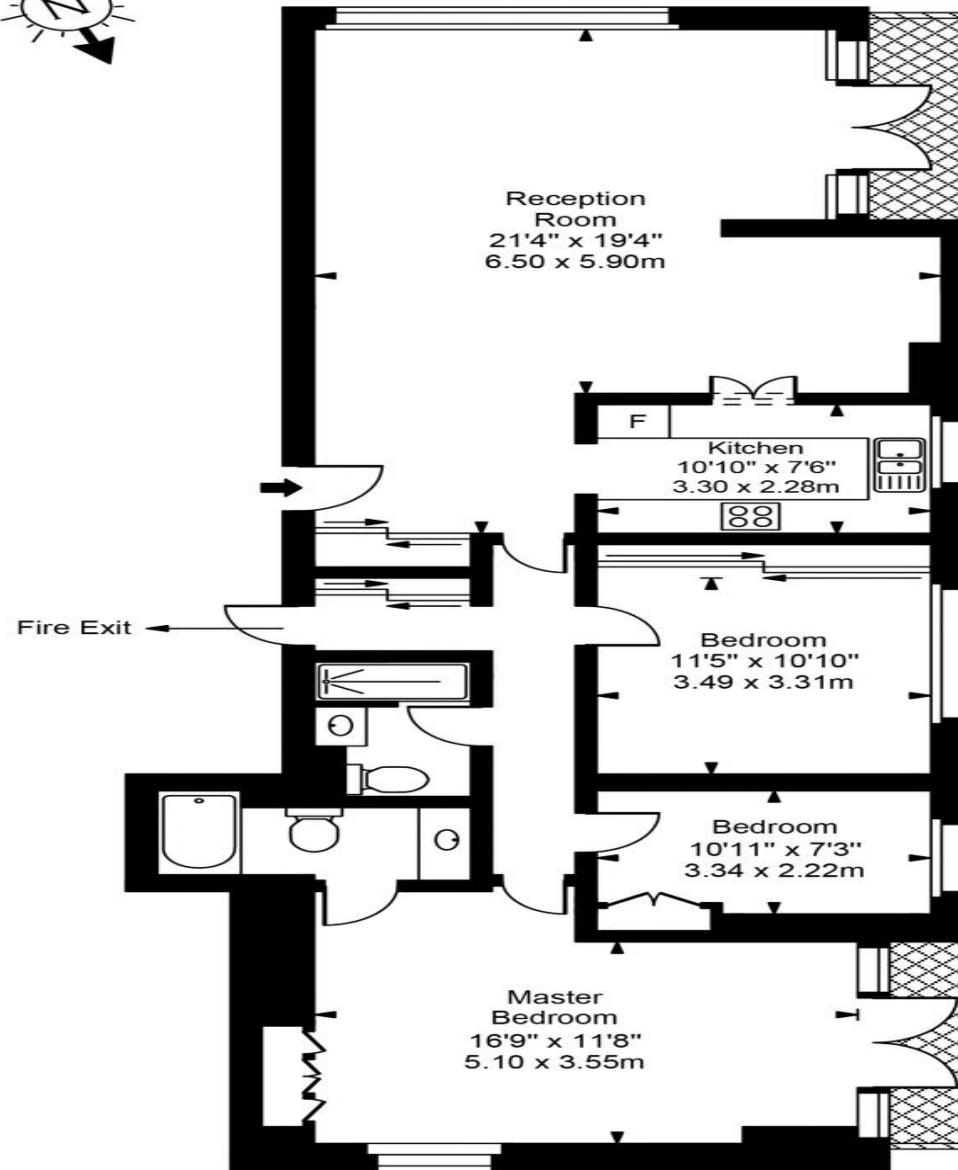
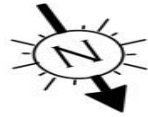

Fourth Floor

Approx Gross Internal Area **1244 Sq Ft - 115.57 Sq M**



For Illustration Purposes Only - Not To Scale  
Floor plan by [www.creativeplanetlk.com](http://www.creativeplanetlk.com)