



Howitt Road, Belsize Park, London, NW3 .| £950,000

- Private garden
- Refurbished to a high standard
- Located in the heart of Belsize Park
- Wooden floors
- Very spacious
- Council tax - E - £1619 per annum

"Vita Properties have been tremendously helpful throughout the process of securing/renting my flat. Informative about the property, prompt communication, easy to use dashboard for sharing of information, and pleasant to work with. Highly recommend!"

A spacious (892 sq ft approx) one bedroom garden flat which has been recently refurbished to a very high standard. The flat comprises a semi open plan fully equipped kitchen. A beautiful marble tiled bathroom with large walk in shower unit. It also boasts Walnut wood flooring and a private garden with access from the living room and a wall mounted LCD TV in lounge.

This stunning flat is offered chain free - planning permission has been granted to excavate the basement





Oliver Kent

✉ [oliver.kent@vitaproperties.uk](mailto:oliver.kent@vitaproperties.uk)  
☎ +4477 7274 0351



 Flat

 x 1

 x 1

 x 1

 x 1



"I was very impressed with Vita and their network of buyers. When the sale of my flat fell through (twice) they worked extremely hard to find new buyers in a difficult market - thank you!"

---

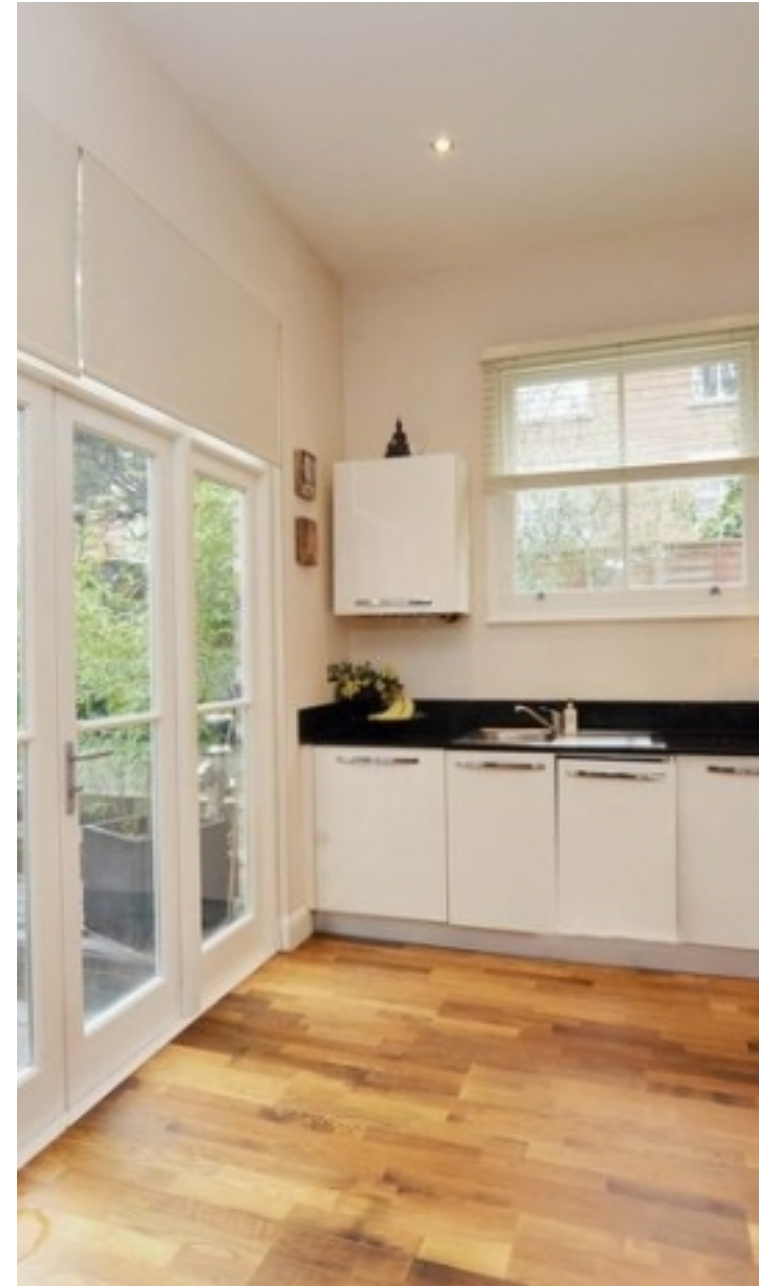

"Working with Vita properties has been a smooth experience! No complaints at all. Our letting agent, Diana has been fantastic and very helpful throughout the whole process. I would highly recommend both Vita properties and Diana."

---





"I used Vita properties to find a flat recently and it was an overall professional, personalised and positive experience. Saira went the extra mile to accommodate to our needs and quick to help us whenever possible."

---



MORE INFO, PICTURES,  
CONTACT ON  
OUR WEBSITE



"Vita Properties is a very professional agency. My experience with them was incredible and the entire team was very helpful and kind throughout the renting process. I'd highly recommend!"

---

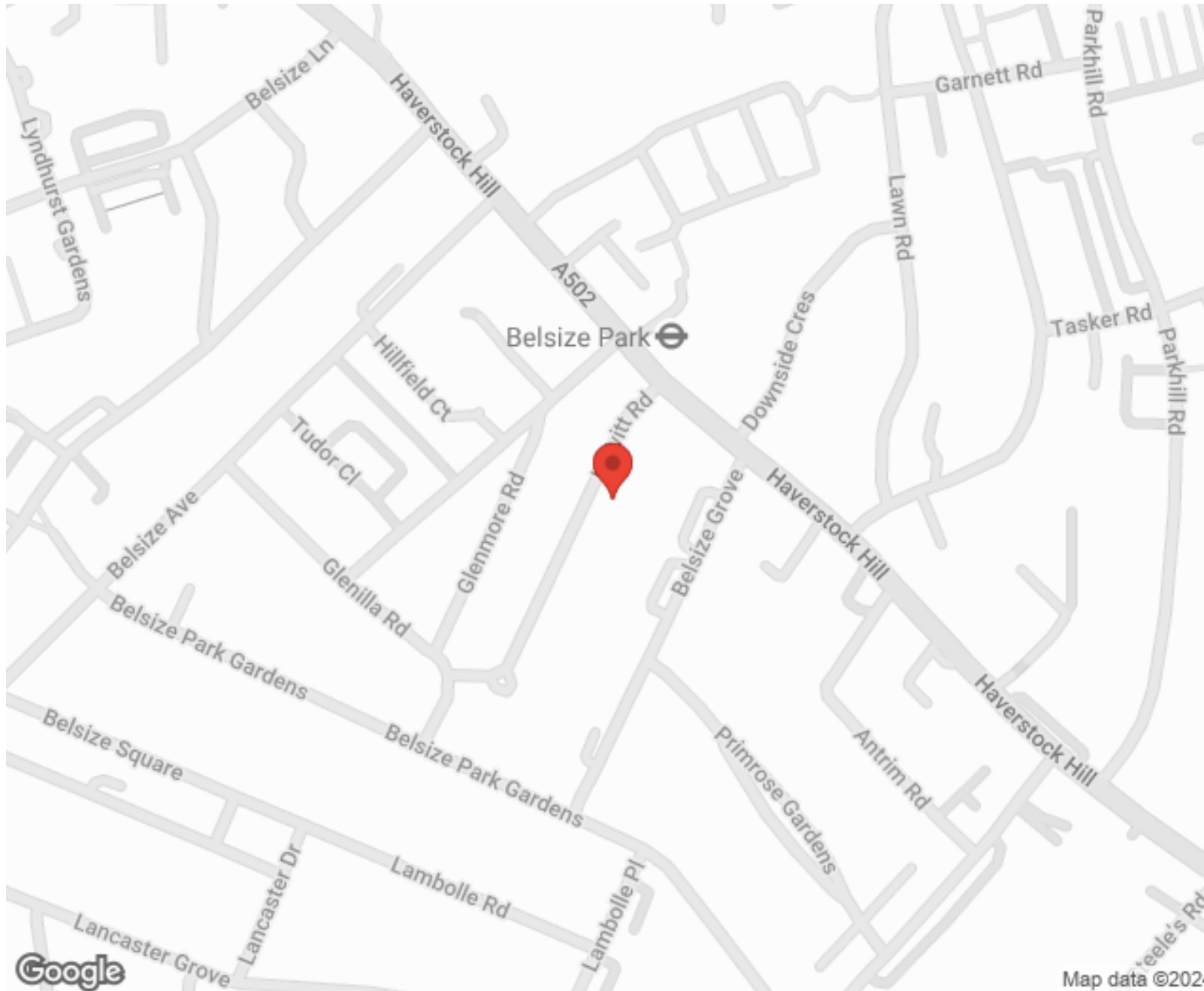

SCAN FOR MORE  
GOOGLE REVIEWS



Google



4.9 Stars | 132 Reviews

Find us on social media

 vitaproperties

 VitaProperties

 VitaProperties

Howitt Road

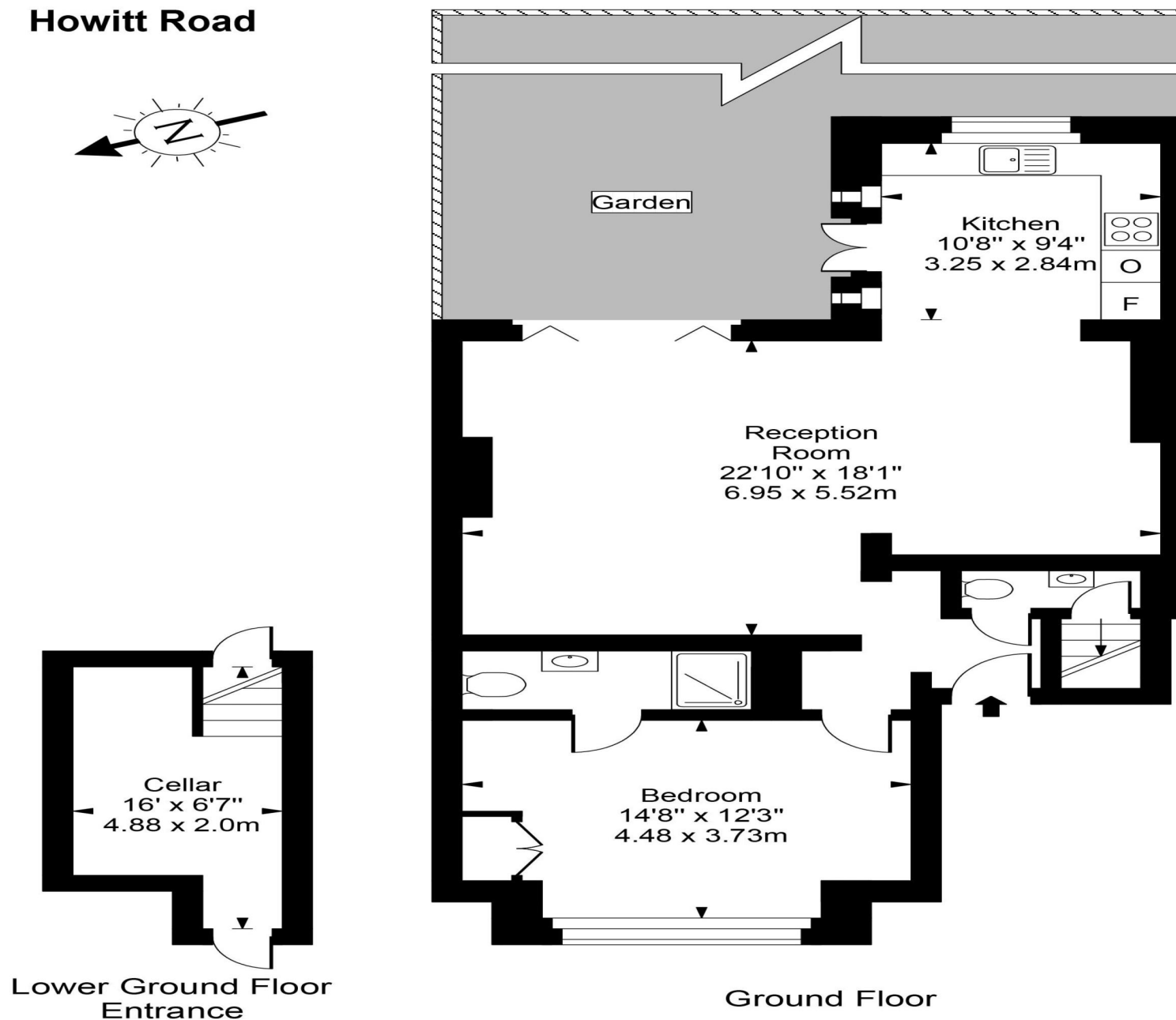
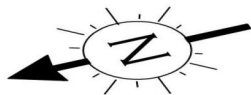

Approx Gross Internal Area **892 Sq Ft - 82.84 Sq M**

For Illustration Purposes Only - Not To Scale  
Floor plan by [www.creativeplanetlk.com](http://www.creativeplanetlk.com)