



Available immediately is this contemporary penthouse apartment situated on the seventh floor of a modern gated development, located minutes from the open spaces of Regents Park. The property, overlooks the communal gardens and comprises four double bedrooms (three rooms have balconies), three bathrooms (two en-suites), a separate eat in kitchen, a guest WC, and a large reception room. Further benefits include wooden floors, a huge South West facing roof terrace, 24hr porter, lift, parking and residents only gym and swimming pool. Palgrave Gardens occupies a quiet position adjacent to Regent's Park and benefits from easy access to Baker Street underground station, Marylebone railway station and the restaurants, shops and amenities of Marylebone High Street and the West End. Offered on an unfurnished basis

- Swimming pool, Gym and Porter
- South West facing private terrace
- Parking
- Communal gardens
- Seconds to Baker Street
- Available immediately

Palgrave Gardens, Regents Park, London NW1

Weekly Rental Of £1,750



Call 020 7759 2199 to view this property, or visit www.vitaproperties.uk for more details

27 Northways Parade, College Crescent, London, NW3 5DN | T: 020 7759 2199 | E: enquiries@vitaproperties.uk
We make all efforts to ensure this information is accurate, but we can't guarantee it.

Palgrave Gardens, Regents Park, London NW1

Weekly Rental Of £1,750



Call 020 7759 2199 to view this property, or visit www.vitaproperties.uk for more details

27 Northways Parade, College Crescent, London, NW3 5DN | T: 020 7759 2199 | E: enquiries@vitaproperties.uk
We make all efforts to ensure this information is accurate, but we can't guarantee it.

Palgrave Gardens, Regents Park, London NW1

Weekly Rental Of £1,750



Call 020 7759 2199 to view this property, or visit www.vitaproperties.uk for more details

27 Northways Parade, College Crescent, London, NW3 5DN | T: 020 7759 2199 | E: enquiries@vitaproperties.uk
We make all efforts to ensure this information is accurate, but we can't guarantee it.

Palgrave Gardens, Regents Park, London NW1

Weekly Rental Of £1,750

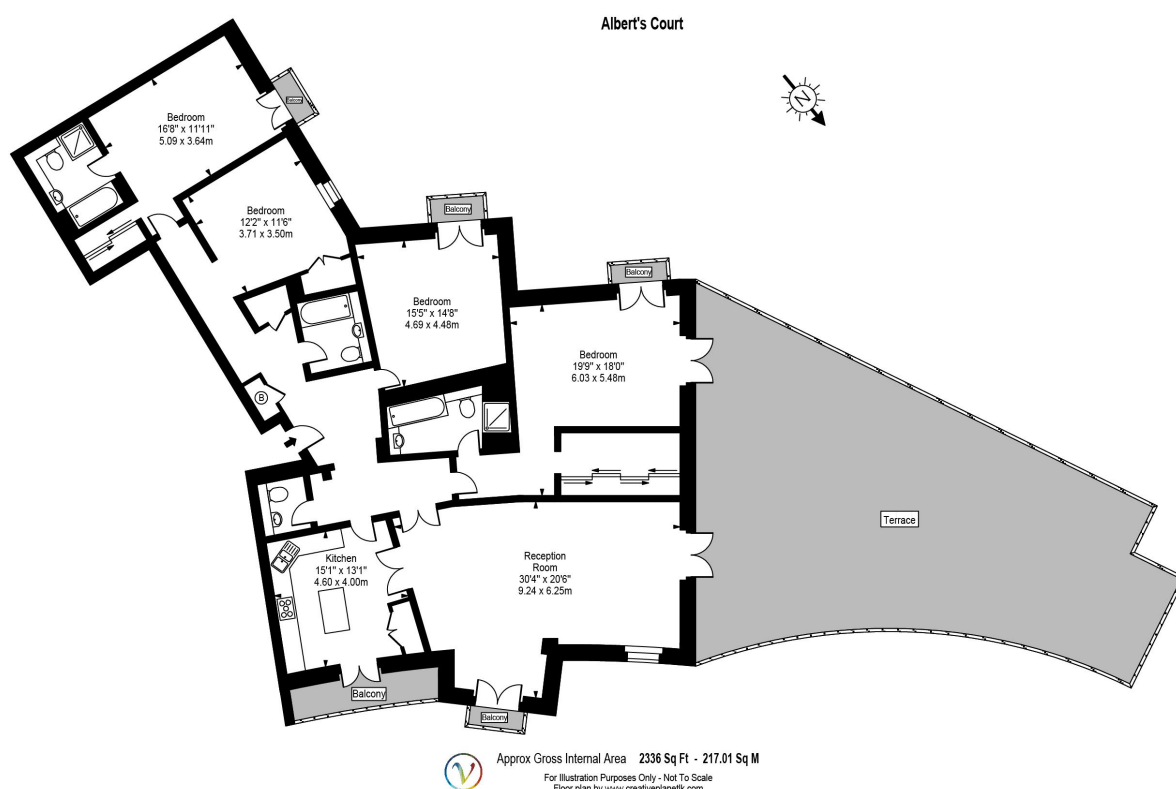

Call 020 7759 2199 to view this property, or visit www.vitaproperties.uk for more details

27 Northways Parade, College Crescent, London, NW3 5DN | T: 020 7759 2199 | E: enquiries@vitaproperties.uk
We make all efforts to ensure this information is accurate, but we can't guarantee it.

